

BRiNK

Notice de pose du faisceau électrique pour crochet
d'attelage avec prise 7 voies type 12N

Version : ALL

Année : 05/2008 →

Réf : 174707



0 H 30

BERLINGO II / PARTNER II

Einbauanleitung elektrosatz Anhängervorrichtung mit 12N Steckdose
Fitting instructions electric wiringkit towbar with 12N socket
Montage-handleiding elektrokabelset voor trekhaak met 12N contactos

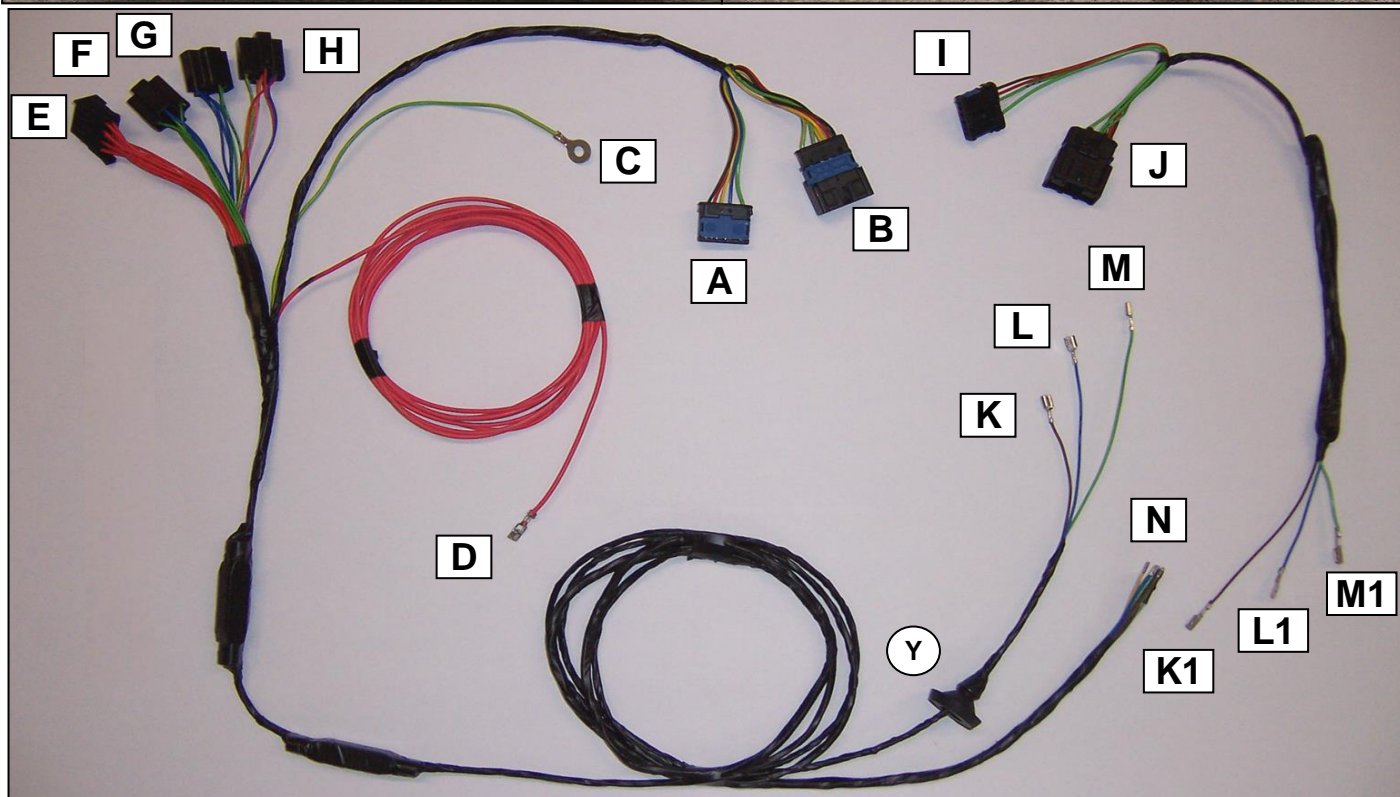
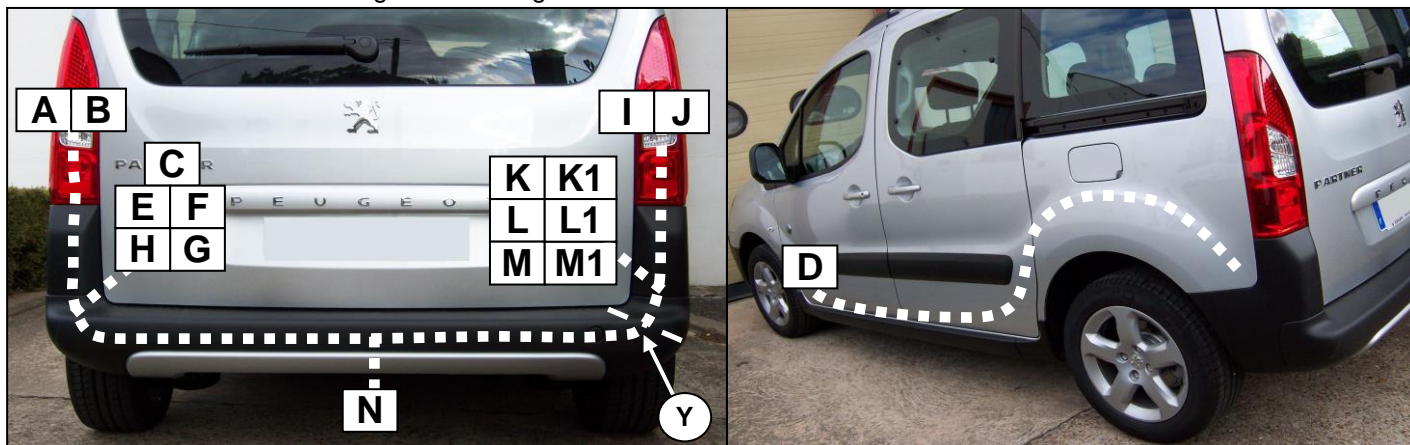

Liste des pièces / Teilliste / Part list / Onderdelenlijst :

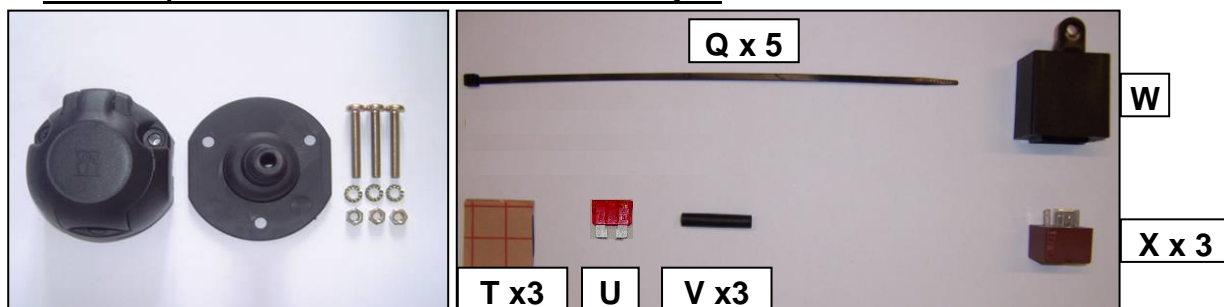

Cette notice ne peut être divulguée ou reproduite, partiellement ou en totalité, sans accord de la société.

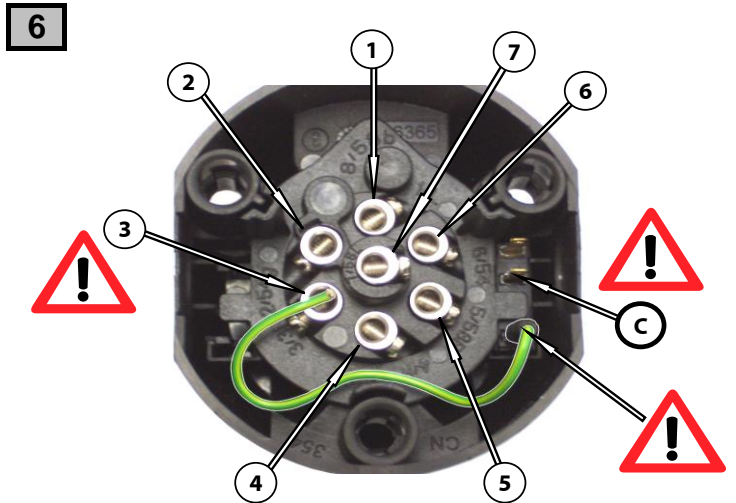
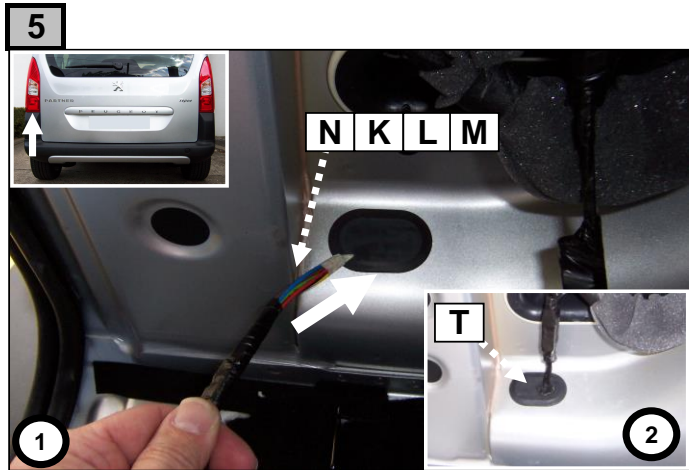
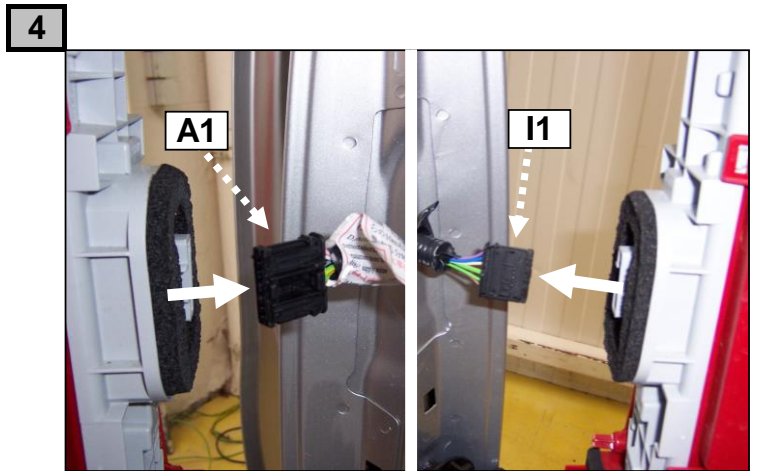
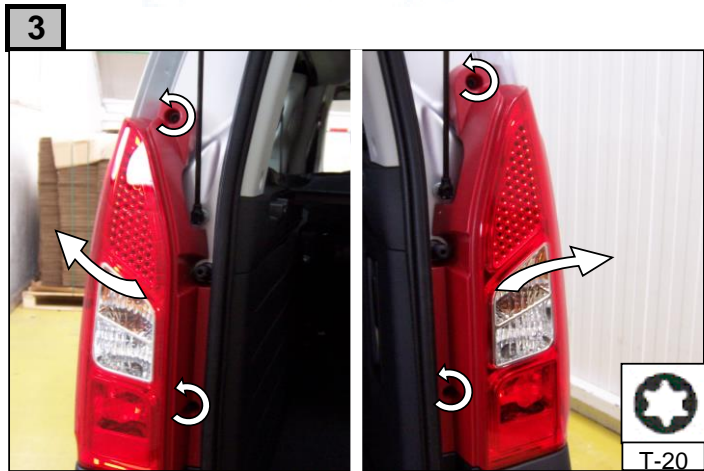
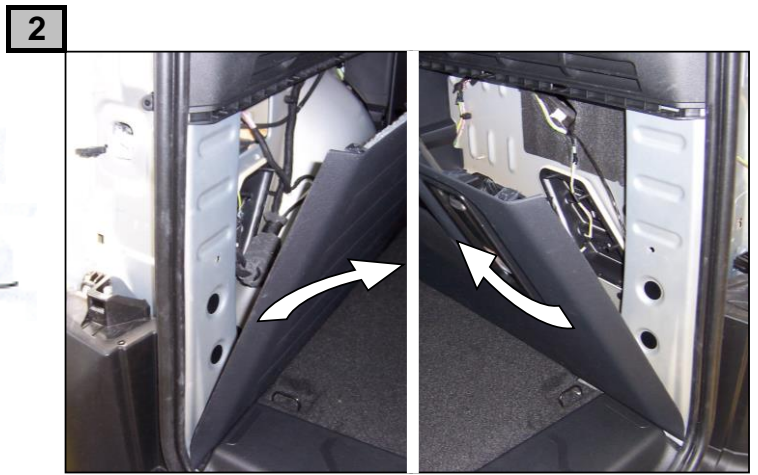
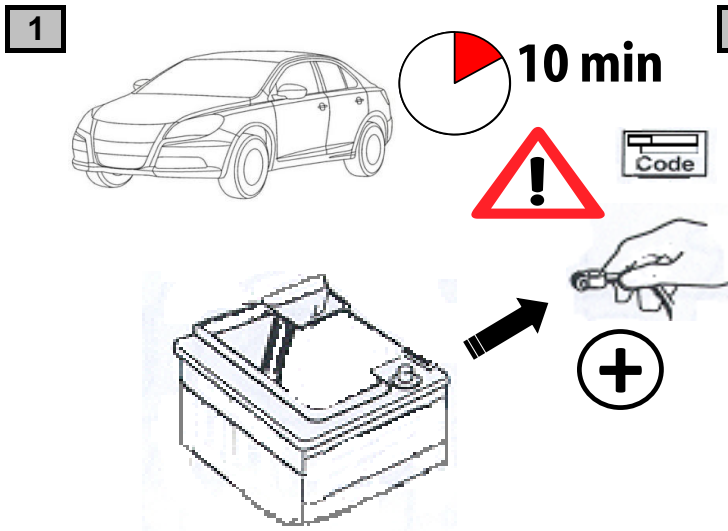

	1/L	2/54g	3/31	4/R	5/58R	6/54	7/58L	(C)
	21+5 W	21W		21+5 W	40 W	63 W	40 W	
F	Jaune	Bleu	Vert/yaune	Vert	Marron	Rouge	Noir	Gris
D	Gelb	Blau	Grün/gelb	Grün	Braun	Rot	Schwarz	Grau
GB	Yellow	Blue	Green/yellow	Green	Brown	Red	Black	Grey
NL	Geel	Blauw	Groen/geel	Groen	Bruin	Rood	Zwart	Grijs
P	Amarelo	Azul	Verde/amarelo	Verde	Castanho	Vermelho	Preto	Cinzeno
I	Giallo	Blu	Verde/giallo	Verde	Marrone	Rosso	Nero	Grigio
E	Amarillo	Azul	Verde/amarillo	Verde	Marron	Rojo	Negro	Gris

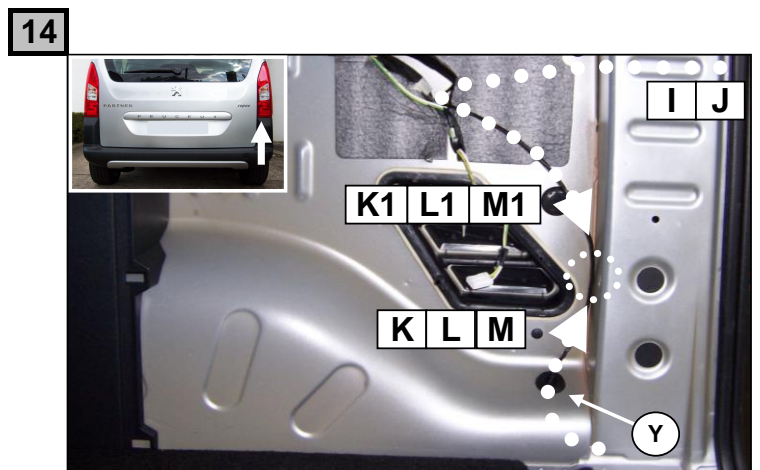
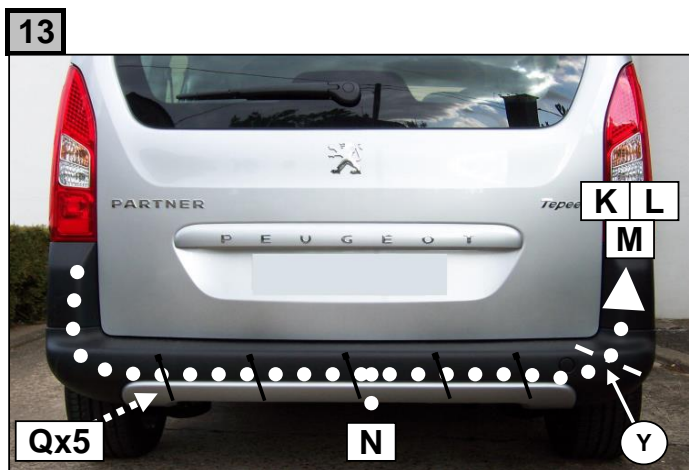
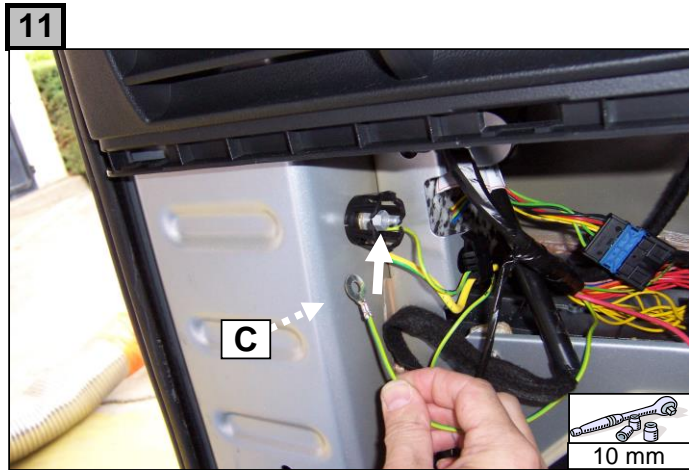
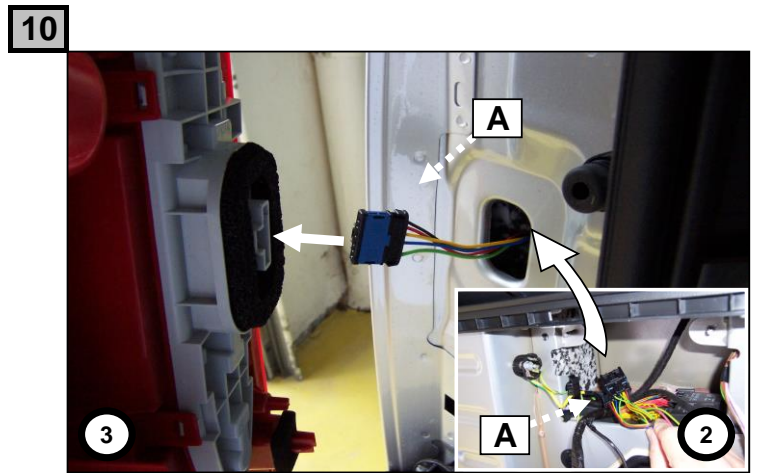
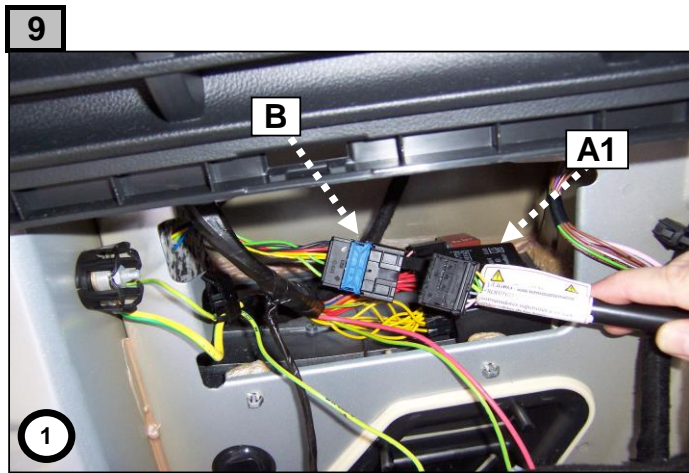
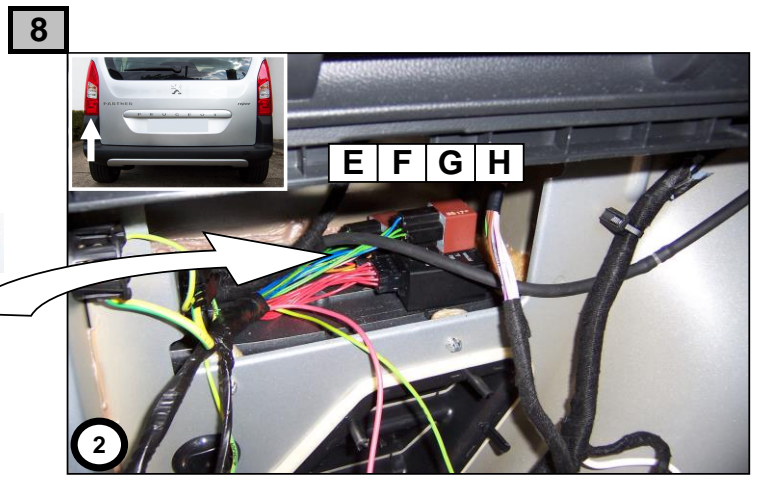
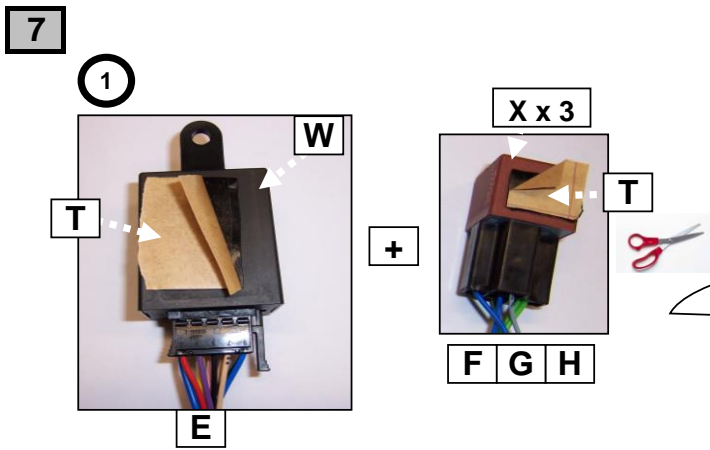

15

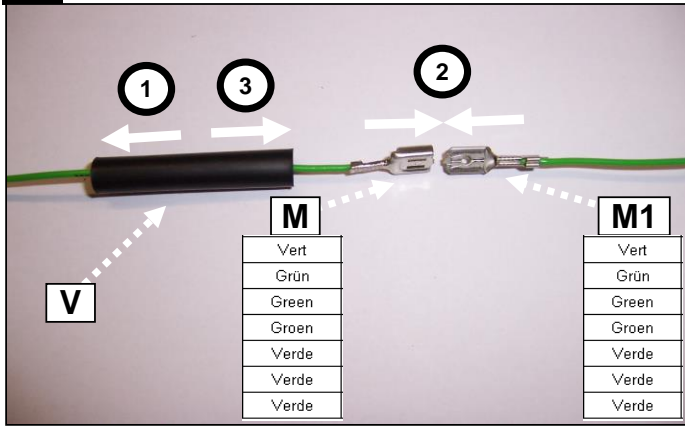

16

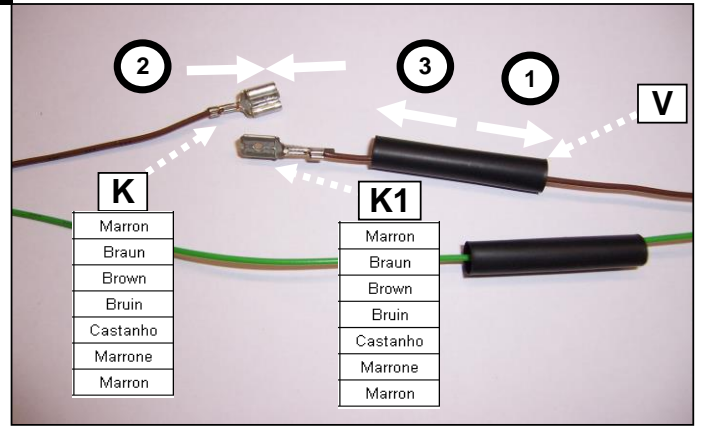

17

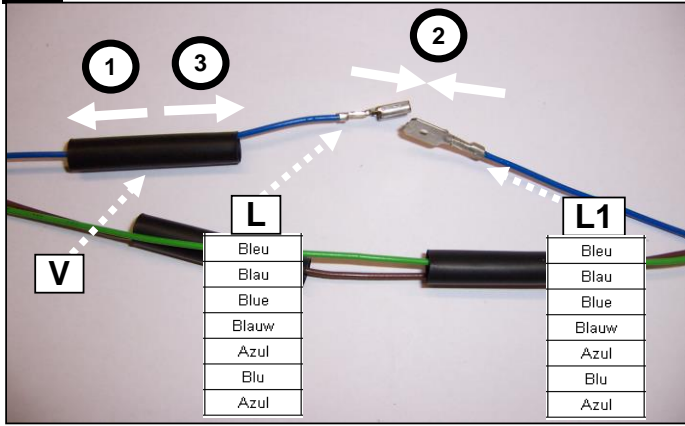

18

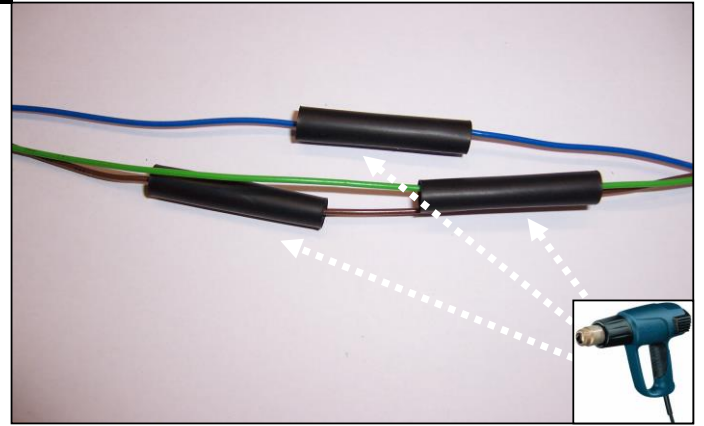

19

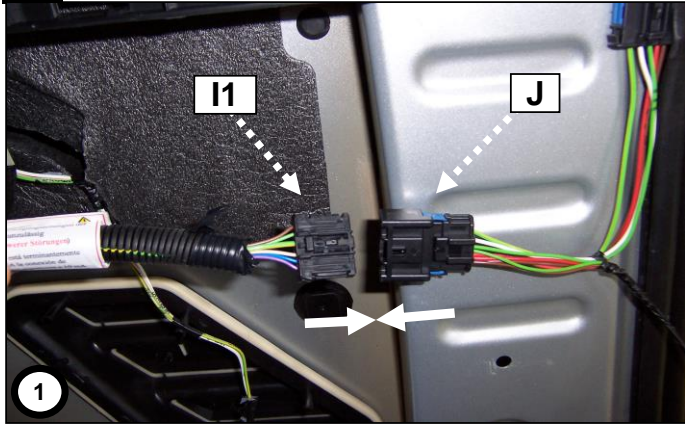

20

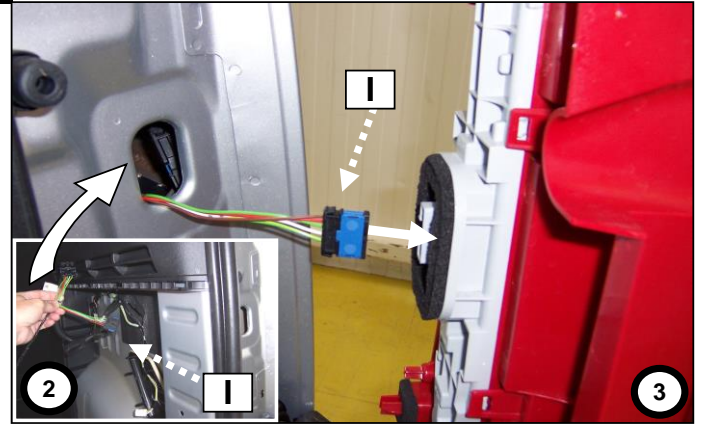

21

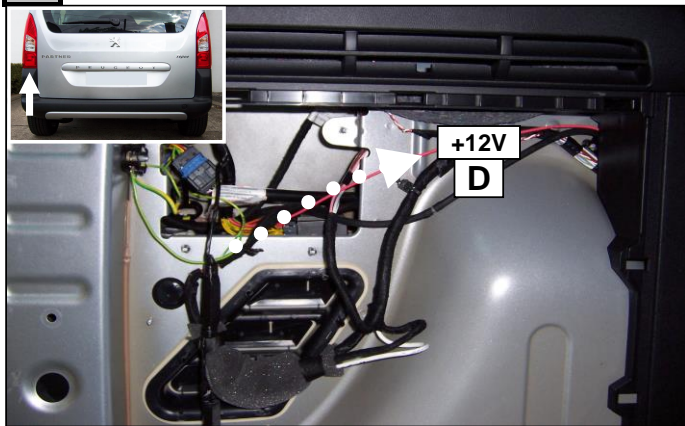

22

Kit d'extension pour alimentation permanente par l'extérieur du véhicule
(Dépendant nous recommandons le passage du câble par l'intérieur)

- (A) Ligne de plomb
- (B) Part kit
- (C) Brûlante
- (D) Ondecolent
- (E) Direct component
- (F) Ligne de composante
- (G) Delizia
- (H) Chulante
- (I) Ligne câble
- (J) Delizia
- (K) Serron d80
- (L) Delize
- (M) Chulante
- (N) Netto nuovament

● ● ● ● ● 100 additional pour alimentation permanente par l'extérieur
■ ■ ■ ■ ■ 100 additional

Cette notice ne peut être reproduite ou révisée, partiellement ou en totalité, sans accord de la société.
Tous droits réservés. Pour plus de détails de nos produits, visitez notre site internet www.robocor.com

23

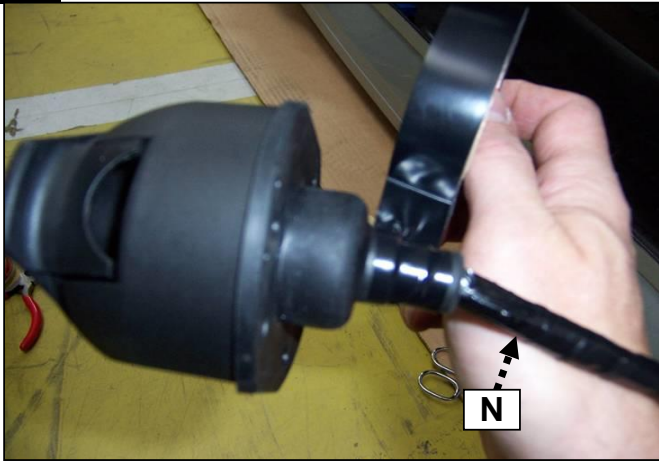

24

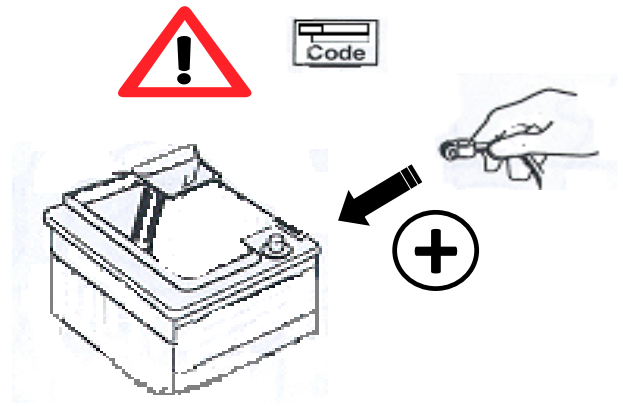

25

- FR** Contrôler les fonctions
- GB** Check functions
- DE** Funktionen kontrollieren
- NL** Controleer functies
- IT** Controllare le funzioni
- ES** Controlar las funciones
- SE** Kontrollera funktionerna
- FI** Tarkista toiminnot
- PL** Sprawdz funkcje
- CZ** Ověřte funkce
- DK** Check funktionerne
- NO** Kontroller funksjonene
- GR** Ελεγχος των λειτουργιών

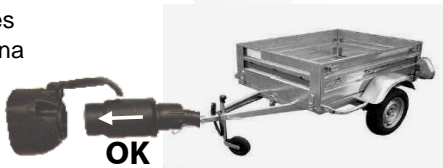

26

