



**DISPOSITIVO DI TRAINO TIPO 43033  
PER AUTOVEICOLI VW TRANSPORTER '90 FURG.**

PER LE SINGOLE VERSIONI E RELATIVI PESI E LARGHEZZE RIMORCHIABILI VEDERE LA TABELLA ALLEGATA

ANNO 1992

mercato di convalida:

MINISTERO DEI TRASPORTI C. S. R. P. A. D. DI ROMA  
APPROVAZIONE AI SENSI DELLA CIRCO. MIN. 20/78 DEL 21-08-78

CARATTERI E GRANDEZZE AL VERO

VERBALE N° 021/92/RM DEL -9 GEN. 1992

ESTREMI D'IDENTIFICAZIONE RIPORTATI SU APPOSITA TARGHETTA

FAC SIMILE TARGHETTA DI IDENTIFICAZIONE

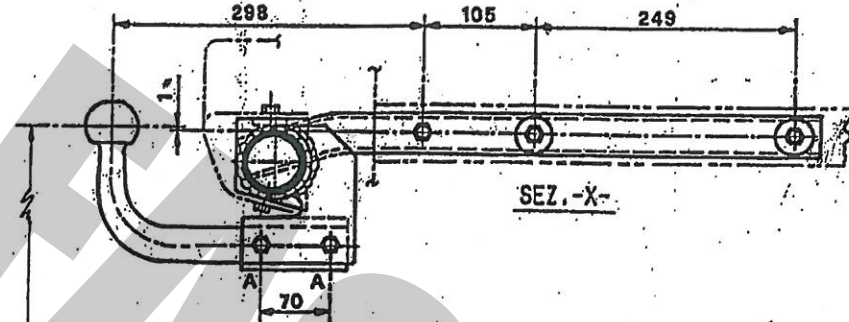

- (A) NR.4 / VITI M10x20-CONTACT
- (B) NR.2 / VITI M10x25-CONTACT-DADI SALDATI
- (C) NR.4 / VITI M10x25-DADI-CONTACT-ROND.Ø40
- (D) NR.4 / DADI M8-CONTACT-VITI ESISTENTI PER FISSAGGIO PARAURTI

STRUTTURA DI TRAINO TIPO	43033
PER AUTOVEICOLO TIPO	VW TRANSP: 90. FURG.
CARICO STATICO SULLA SFERA kg	
APPR. C.S.R.P.A.D.-RM VERBALE N°	21/92 RM
06080 S. SISTO (PG)	

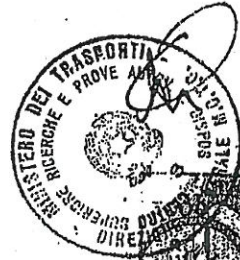

IL DIRETTORE  
DOTT. ING. ...

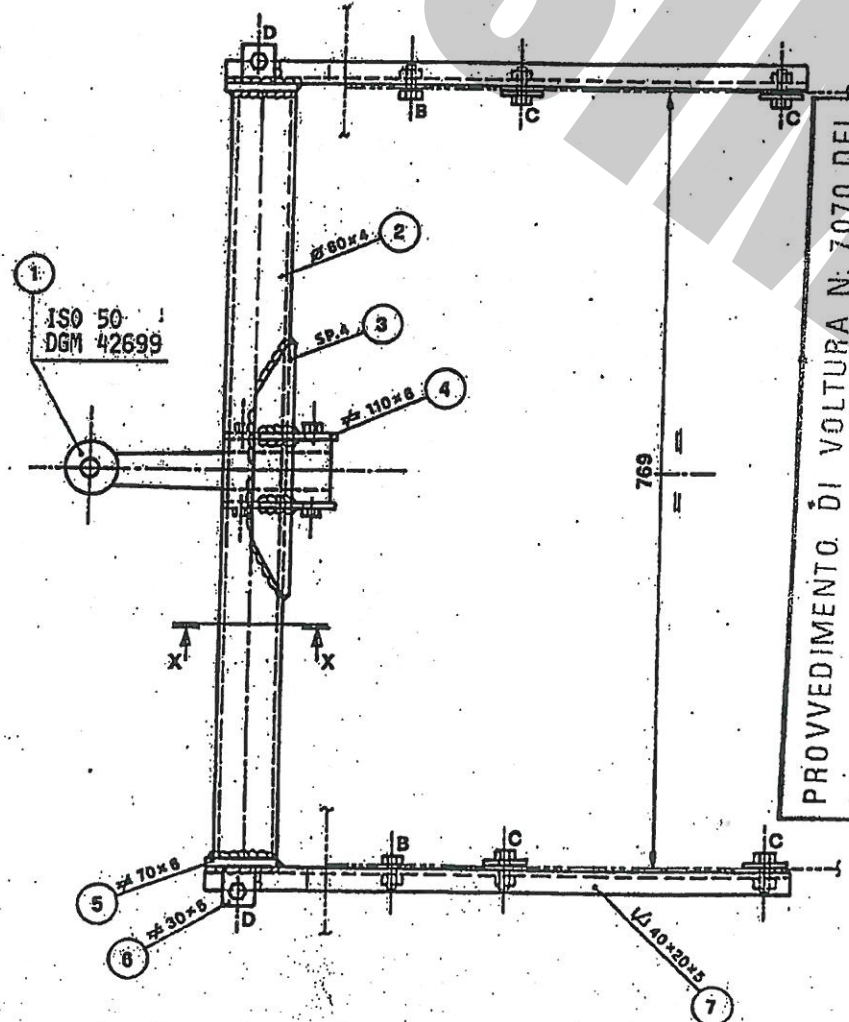

PROVVEDIMENTO DI VOLTURA N: 7070 DEL  
5-12-94 A FAVORE DI UMBRA RIMORCHI S.R.L.

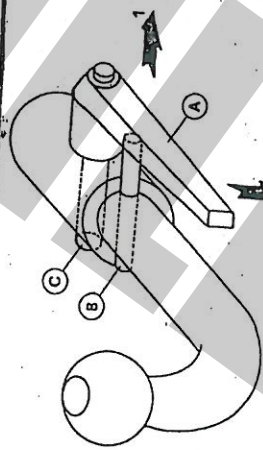

- DISPOSITIVO DI TRAINO AD ESTRAZIONE RAPIDA DELLA SFERA -MOD. C-
- 1) ALZARE LA LEVA -A- E RUOTARLA IN MODO DA SCAVALCARE IL PERNO -B-
  - 2) LASCIARE LA LEVA -A- E RUOTARLA IN MODO DA SBLOCCARE IL PERNO ECCENTRICO -C-
  - 3) TIRARE LA LEVA E SFILARE IL PERNO DI FISSAGGIO -C-

IL PRESENTE DOCUMENTO HA VALIDITÀ UNICAMENTE SE CONVALIDATO CON MARCHIO UMBRA RIMORCHI - STAMPATO A SECCO

 marchio di fabbrica PER LE SINGOLE VERSIONI E RELATIVI PESI E LARGHEZZE RIMORCHIABILI VEDERE LA TABELLA ALLEGATA	<b>DISPOSITIVO DI TRAINO TIPO 43033</b> <b>PER AUTOVEICOLI VW TRANSPORTER "90"</b>	ANNO 1992
	MINISTERO DEI TRASPORTI G. S. R. P. A. D. DI ROMA APPROVAZIONE AI SENSI DELLA CIRCO. MIN. 20/76 DEL 21-06-76	<b>VERBALE N° 21/92/27 DEL 9 GEN. 1992</b>

TABELLA MASSE RIMORCHIABILI

OM	VERSIONI E MODELLI	MASSA RIMORCHIA-BILE KG	LARGHEZZA MAX RIMORCHIA-BILE SU STRADA MT	CARICO STATICO SU STRADA KG
52598-B-C-D-E-G-H-I	70 VERS. X0 AB1X20K2	1500	2,50	75
EST 01-B-C-D-E-G-H-I	" AB1X20K1	"	"	"
04-B-C-D-E-G-H-I	"	"	"	"
P-R-S-T-U-V-W-X-Y-Z-BB-	"	"	"	"
BC-BD-BE-BG-BH-BJ-BK-BL-	"	"	"	"
BM-BN-BP-BR-BS-BT-BU-BV-	"	"	"	"
BN-BX-BY-BZ-CB-CC-CD-CE-	"	"	"	"
CG	"	"	"	"
05-B-C-D-E-G-H-I	BC1X20K2	"	"	"
P-R-S-T	"	"	"	"
06-B-C-D-E-G-H-I	ABAAC20K2	"	"	"
P-R-S-T	"	"	"	"
09-B-C-D-E-G-H-I	ABAAC20K1	"	"	"
P-R-S-T	"	"	"	"
10-B-C-D-E-G-H-I	BCAAC20K2	"	"	"
11-B-C-D-E-G-H-I	ABAAB20K2	"	"	"
12-B-C-D-E-G-H-I	ABAAB20K1	"	"	"
15-B-C-D-E-G-H-I	ABAAB20K2A	"	"	"
P-R-S-T-U-V-W-X-Y-Z-BB-	"	"	"	"
BC-BD-BE-BG-BH-BJ-BK-BL-	"	"	"	"
BM-BN-BP-BR-BS-BT-BU-BV-	"	"	"	"
BN-BX-BY-BZ-CB-CC-CD-CE-	"	"	"	"
CG	"	"	"	"
16-B-C-D-E-G-H-I	BCAAB20K2	"	"	"
17-B-C-D-E-G-H-I	ABAAB20K2	"	"	"
18-B-C-D-E-G-H-I	ABAAB20K1	"	"	"
21-B-C-D-E-G-H-I	ABAAB20K2A	"	"	"
P-R-S-T-U-V-W-X-Y-Z-BB-	"	"	"	"
BC-BD-BE-BG-BH-BJ-BK-BL-	"	"	"	"
BM-BN-BP-BR-BS-BT-BU-BV-	"	"	"	"
BN-BX-BY-BZ-CB-CC-CD-CE-	"	"	"	"
CG	"	"	"	"
22-B-C-D-E-G-H-I	BCAAE20K2	"	"	"
25-B-C-D-E-G-H-I	AB1X20K3	1700	"	100
P-R-S-T-U-V-W-X-Y-Z-BB-	"	"	"	"
BC	"	"	"	"
26-B-C-D-E-G-H-I	BC1X20K3	"	"	"
P-R-S-T	"	"	"	"
29-B-C-D-E-G-H-I	ABAAC20K3	"	"	"
P-R-S-T-U-V-W-X-Y-Z-BB-	"	"	"	"
BC-BD-BE-BG-BH-BJ-BK-BL-	"	"	"	"
BM-BN-BP-BR-BS-BT-BU-BV-	"	"	"	"
BN-BX-BY-BZ-CB-CC-CD-CE-	"	"	"	"
CG	"	"	"	"
30-B-C-D-E-G-H-I	BCAAC20K3	"	"	"
33-B-C-D-E-G-H-I	ABAAB20K3	"	"	"
P-R-S-T-U-V-W-X-Y-Z-BB-	"	"	"	"
BC	"	"	"	"
34-B-C-D-E-G-H-I	BCAAB20K3	"	"	"
37-B-C-D-E-G-H-I	ABAAB20K3	"	"	"
P-R-S-T-U-V-W-X-Y-Z-BB-	"	"	"	"
BC	"	"	"	"
	BCAAE20K3	"	"	"

Prot. 5503 del 22-11-91  
 operaziona 16.RHC066451  
 negli autoveicoli sopra indicati  
 può essere applicata  
 la tabella allegata con le  
 n. 02/192/27 del 9 GEN. 1992  
 C. S. S. P. A. D.  
 II. INC. 20/76

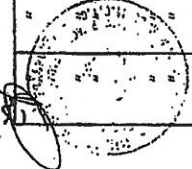

 marchio di fabbrica PER LE SINGOLE VERSIONI E RELATIVI PESI E LARGHEZZE RIMORCHIABILI VEDERE LA TABELLA ALLEGATA	<b>DISPOSITIVO DI TRAINO TIPO 43033</b> <b>PER AUTOVEICOLI VOLKSWAGEN TRANSPORTER "90"</b>	ANNO 1992
	MINISTERO DEI TRASPORTI G. S. R. P. A. D. DI ROMA APPROVAZIONE AI SENSI DELLA CIRCO. MIN. 20/76 DEL 21-06-76	<b>VERBALE N° 021/92/RM DEL 09.01.92</b>

TABELLA MASSE RIMORCHIABILI

OM	VERSIONI E MODELLI	MASSA RIMORCHIA-BILE KG	LARGHEZZA MAX RIMORCHIA-BILE SU STRADA MT	CARICO STATICO SU STRADA KG
52598	70 VERS. X0	1500	2,50	75
EST 04CU-CV-CW-CX-CY-CZ-DB-DC	BC 1X 20K2	"	"	"
09BN-GP-GR-GS-GT-GU-GV-GW	BC AAB 20K2	1500	"	"
" 15CU-CV-CW-CX-CY-CZ-DB-DC	BC AAF 20K2	1600	"	"
" 21CU-CV-CW-CX-CY-CZ-DB-DC	BN 1X 20K2	1500	"	"
94-B	BN AAG 20K2	1500	"	"
95-B-C-D	BN AAB 20K2	1600	"	"
96-B	BN AAF 20K2	1500	"	"
97-B	BN ABL 20K1	1650	"	100
98-B-C-D-E-G-H-I	AB ABL 20K1	1500	"	75
99-B-C-D-E-G-H-I	AB ABL 20K2	"	"	"
100-B-C-D-E-G-H-I	AB ABL 20K3	1350	"	"
P-R-S-T-U-V-W-X-Y-Z-BB-	"	"	"	"
BC-BD-BE-BG-BH-BJ-BK-BL-	"	"	"	"
BM-BN-BP-BR-BS-BT-BU-BV-	"	"	"	"
BN-BX-BY-BZ-CB-CC-CD-CE-	"	"	"	"
CG	"	"	"	"
105	BC ABL 20K2	1500	"	"
P-R-S-T-U-V-W-X-Y-Z-BB-	"	"	"	"
BC	BN ABL 20K2	1600	"	"
106-B-C-D-E-G-H-I	BC ABL 20K3	1300	"	"
107-B-C-D-E-G-H-I	AB ABL 20L2	1400	"	"
108-B-C-D-E-G-H-I	AB ABL 20L2A	1500	"	"
109-B-C-D-E-G-H-I	BC ABL 20L2	1250	"	"
110-B-C-D-E-G-H-I	"	"	"	"
117-B-C-D-E-G-H-I	"	"	"	"
P-R-S-T-U-V-W-X-Y-Z-BB-	"	"	"	"
BC-BD-BE-BG-BH-BJ-BK-BL-	"	"	"	"
BM-BN-BP-BR-BS-BT-BU-BV-	"	"	"	"
BN-BX-BY-BZ-CB-CC-CD-CE-	"	"	"	"
CG	"	"	"	"
118-B-C-D-E-G-H-I	BC ABL 20L2	1500	"	"
P-R-S-T-U-V-W-X-Y-Z-BB-	"	"	"	"
BC-BD-BE-BG-BH-BJ-BK-BL-	"	"	"	"
BM-BN-BP-BR-BS-BT-BU-BV-	"	"	"	"
BN-BX-BY-BZ-CB-CC-CD-CE-	"	"	"	"
CG	"	"	"	"

Imposta di bollo  
 assolta mediante  
 versamento in c/c  
 postale al n° 9041  
 dell'ent. 7 sede  
 legge 13-10-78,  
 n° 625

Prot. 4777 del 15 MAR. 1993  
 operaziona 25.ETI.01.5.91

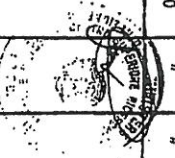



DISPOSITIVO DI TRAINO TIPO 43033  
PER AUTOVEICOLI VM TRANSPORTER "90"  
PER LE SINGOLE VERSIONI E RELATIVI PESI E LARGHEZZE RIMORCHIABILI VEDERE LA TABELLA ALLEGATA

ANNO 1992  
PAG. 1/2  
ESTREMI IDENTIFICAZIONE RIPORTATI SU APPOSITA TARGHETTA

MINISTERO DEI TRASPORTI C. S. R. P. A. D. DI ROMA  
APPROVAZIONE AI SENSI DELLA CIRCO. MIN. 20/76 DEL 21-06-76  
VERBALE N° 021/92/RM DEL 09.01.92

1° AGGIORNAMENTO PER INTRODUZIONE NUOVE VERSIONI

TABELLA MASSE RIMORCHIABILI

OM	VERSIONI E MODELLI	MASSA RIMORCHIA-BILE KG	LARGHEZZA MAX RIMORCHIA-BILE MT	CARICO STATICO SU SEBIA KG
52598	EST 04CH-CJ-CK-CL-CM-CN-CP-CR	70 VERS. X0 BC1X20K2	2.50	75
"	CS-CT	"	"	"
"	09EP-ER-ES-ET-EU-EV-EM-EX-EY-EZ-GB-GC-GD-GE-GG-GH-GJ-GK-GL-GM	"	"	"
"	15CH-CJ-CK-CL-CM-CN-CP-CR	"	"	"
"	CS-CT	"	"	"
"	21CH-CJ-CK-CL-CM-CN-CP-CR-CP-CT	"	"	"
"	38-B-C-D-E-G-H-J	"	"	"
"	39-B-C-D-E-G-H-J	"	"	"
"	44-B-C-D-E-G-H-J-K-L-M-N-P-R-S-T-U-V-W-X-Y-Z-BB-BC-BD-BE-BG-BH-BJ-BK-BL-BM-BN-BP-BR-BS-BT-BU-BV-BW-BX-BY-BZ-CB-CC-CD-CE-CG-CH-CJ-CK-CL-CM-CN-CP-CR-CT	"	"	"
"	45-B-C-D-E-G-H-J-K-L-M-N-P-R-S-T	"	"	"
"	46-B-C-D-E-G-H-J-K-L-M-N-P-R-S-T	"	"	"
"	51-B-C-D-E-G-H-J-K-L-M-N-P-R-S-T-U-V-W-X-Y-Z-BB-BC-BD-BE-BG-BH-BJ-BK-BL-BM-BN-BP-BR-BS-BT-BU-BV-BW-BX-BY-BZ-CB-CC-CD-CE-CG-CH-CJ-CK-CL-CM-CN-CP-CR-CT	"	"	"
"	52-B-C-D-E-G-H-J	"	"	"
"	53-B-C-D-E-G-H-J	"	"	"
"	60-B-C-D-E-G-H-J-K-L-M-N-P-R-S-T-U-V-W-X-Y-Z-BB-BC-BD-BE-BG-BH-BJ-BK-BL-BM-BN-BP-BR-BS-BT-BU-BV-BW-BX-BY-BZ-CB-CC-CD-CE-CG-CH-CJ-CK-CL-CM-CN-CP-CR-CT	"	"	"
"	61-B-C-D-E-G-H-J	"	"	"
"	62-B-C-D-E-G-H-J	"	"	"
"	69-B-C-D-E-G-H-J-K-L-M-N-P-R-S-T-U-V-W-X-Y-Z-BB-BC-BD-BE-BG-BH-BJ-BK-BL-BM-BN-BP-BR-BS-BT-BU-BV-BW-BX-BY-BZ-CB-CC-CD-CE-CG-CH-CJ-CK-CL-CM-CN-CP-CR-CT	"	"	"
"	70-B-C-D-E-G-H-J	"	"	"
"	73-B-C-D-E-G-H-J-K-L-M-N-P-R-S-T-U-V-W-X-Y-Z-BB-BC-BD-BE-BG-BH-BJ-BK-BL-BM-BN-BP-BR-BS-BT-BU-BV-BW-BX-BY-BZ-CB-CC-CD-CE-CG-CH-CJ-CK-CL-CM-CN-CP-CR-CT	"	"	"

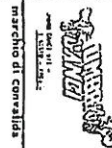

DISPOSITIVO DI TRAINO TIPO 43033  
PER AUTOVEICOLI VM TRANSPORTER "90"  
PER LE SINGOLE VERSIONI E RELATIVI PESI E LARGHEZZE RIMORCHIABILI VEDERE LA TABELLA ALLEGATA

ANNO 1992  
PAG. 2/2  
ESTREMI IDENTIFICAZIONE RIPORTATI SU APPOSITA TARGHETTA

MINISTERO DEI TRASPORTI C. S. R. P. A. D. DI ROMA  
APPROVAZIONE AI SENSI DELLA CIRCO. MIN. 20/76 DEL 21-06-76  
VERBALE N° 021/92/RM DEL 09.01.92

1° AGGIORNAMENTO PER INTRODUZIONE NUOVE VERSIONI

TABELLA MASSE RIMORCHIABILI

OM	VERSIONI E MODELLI	MASSA RIMORCHIA-BILE KG	LARGHEZZA MAX RIMORCHIA-BILE MT	CARICO STATICO SU SEBIA KG
52598	EST 74-B-C-D-E-G-H-J-K-L-M-N-P-R-S-T	70 VERS. X0 ABAA20L3	2.50	100
"	77-B-C-D-E-G-H-J-K-L-M-N-P-R-S-T-U-V-W-X-Y-Z-BB-BC-BD-BE-BG-BH-BJ-BK-BL-BM-BN-BP-BR-BS-BT-BU-BV-BW-BX-BY-BZ-CB-CC-CD-CE-CG-CH-CJ-CK-CL-CM-CN-CP-CR-CT	"	"	"
"	81-B-C-D-E-G-H-J-K-L-M-N-P-R-S-T-U-V-W-X-Y-Z-BB-BC-BD-BE-BG-BH-BJ-BK-BL-BM-BN-BP-BR-BS-BT-BU-BV-BW-BX-BY-BZ-CB-CC-CD-CE-CG-CH-CJ-CK-CL-CM-CN-CP-CR-CT	"	"	"
"	82-B-C-D-E-G-H-J	"	"	"
"	83-B-C-D-E-G-H-J	"	"	"
"	86-B-C-D-E-G-H-J-K-L-M-N-P-R-S-T-U-V-W-X-Y-Z-BB-BC-BD-BE-BG-BH-BJ-BK-BL-BM-BN-BP-BR-BS-BT-BU-BV-BW-BX-BY-BZ-CB-CC-CD-CE-CG-CH-CJ-CK-CL-CM-CN-CP-CR-CT	"	"	"
"	87-B-C-D-E-G-H-J-K-L-M-N-P-R-S-T-U-V-W-X-Y-Z-BB-BC-BD-BE-BG-BH-BJ-BK-BL-BM-BN-BP-BR-BS-BT-BU-BV-BW-BX-BY-BZ-CB-CC-CD-CE-CG-CH-CJ-CK-CL-CM-CN-CP-CR-CT	"	"	"
"	88-B-C-D-E-G-H-J-K-L-M-N-P-R-S-T-U-V-W-X-Y-Z-BB-BC-BD-BE-BG-BH-BJ-BK-BL-BM-BN-BP-BR-BS-BT-BU-BV-BW-BX-BY-BZ-CB-CC-CD-CE-CG-CH-CJ-CK-CL-CM-CN-CP-CR-CT	"	"	"
"	89-B-C-D-E-G-H-J-K-L-M-N-P-R-S-T-U-V-W-X-Y-Z-BB-BC-BD-BE-BG-BH-BJ-BK-BL-BM-BN-BP-BR-BS-BT-BU-BV-BW-BX-BY-BZ-CB-CC-CD-CE-CG-CH-CJ-CK-CL-CM-CN-CP-CR-CT	"	"	"
"	90-B-C-D-E-G-H-J-K-L-M-N-P-R-S-T-U-V-W-X-Y-Z-BB-BC-BD-BE-BG-BH-BJ-BK-BL-BM-BN-BP-BR-BS-BT-BU-BV-BW-BX-BY-BZ-CB-CC-CD-CE-CG-CH-CJ-CK-CL-CM-CN-CP-CR-CT	"	"	"
"	91-B-C-D-E-G-H-J-K-L-M-N-P-R-S-T-U-V-W-X-Y-Z-BB-BC-BD-BE-BG-BH-BJ-BK-BL-BM-BN-BP-BR-BS-BT-BU-BV-BW-BX-BY-BZ-CB-CC-CD-CE-CG-CH-CJ-CK-CL-CM-CN-CP-CR-CT	"	"	"
"	92-B-C-D-E-G-H-J-K-L-M-N-P-R-S-T-U-V-W-X-Y-Z-BB-BC-BD-BE-BG-BH-BJ-BK-BL-BM-BN-BP-BR-BS-BT-BU-BV-BW-BX-BY-BZ-CB-CC-CD-CE-CG-CH-CJ-CK-CL-CM-CN-CP-CR-CT	"	"	"
"	93-B-C-D-E-G-H-J-K-L-M-N-P-R-S-T-U-V-W-X-Y-Z-BB-BC-BD-BE-BG-BH-BJ-BK-BL-BM-BN-BP-BR-BS-BT-BU-BV-BW-BX-BY-BZ-CB-CC-CD-CE-CG-CH-CJ-CK-CL-CM-CN-CP-CR-CT	"	"	"

Imposta di bollo assoluta mediante versamento in c/c postale al senno dell'art. 7 della legge 10-10-70, n° 625

Prot. 2506 del 28 APR 1992  
operazioni 25/21/460  
ocli cattedratici sopra indicati può essere richiesta la struttura di tutto appropria da versare 021/92/RM del 09.01.92 C. S. R. P. A. D.

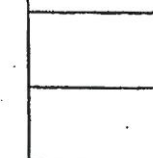





DISPOSITIVO DI TRAINO TIPO 43033  
PER AUTOVEICOLI

ANNO 1992

S. SISTO - PG

VW TRANSPORTER "90"

marchio di convalida

PER LE SINGOLE VERSIONI E RELATIVI PESI E LARGHEZZE  
RIMORCHIABILI VEDERE LA TABELLA ALLEGATA

PAG. 1/4

MINISTERO DEI TRASPORTI C. S. R. P. A. D. DI ROMA  
APPROVAZIONE AI SENSI DELLA CIRC. MIN. 20/76 DEL 21-06-76

ESTREMI D'IDENTIFICAZIONE  
RIPORTATI SU APPOSITA  
TARGHETTA

VERBALE N° 021/92/RM DEL 09.01.92

5° AGGIORNAMENTO PER INTRODUZIONE NUOVE VERSIONI

TABELLA MASSE RIMORCHIABILI

OM	VERSIONI E MODELLI	MASSA RIMORCHIA-BILE KG	LARGHEZZA MAX RIMORCHIE -MT	CARICO STATICO SU SFERA KG
52598				
EST. 119K-L	70 VERS. X1 ABAAB20K1	2000	2.50	100
" 122CR-CS-CT-CU-CV-CW-CX-	" " " BCAAB20K1	1950	"	"
" CY-CZ-DB-DC-DD-DE-DG-DJ	" " " BNAAB20K1	2000	"	"
" 123C-D	" " " ABAAB20K2	1750	"	"
" 124K-L	" " " BCAAB20K2	"	"	"
" 127Y-Z-BB-BC-BD	" " " ABAAB20L1	2000	"	"
" 128U-V-W-X	" " " BCAAB20L1	1900	"	"
" 133DD-DE-DG-DH-DJ-DK-DL-	" " " ABAAB20L2	1750	"	"
" DM-DN-DR-DS-DT-DU-	" " " BCAAB20L2	1700	"	"
" DV-DW-DX-DY-DZ-EB	" " " ABACV20K1	2000	"	"
" 134U-V-W-X	" " " ABACV20K2	1900	"	"
" 137DB-DC-DD-DE-DG-DH-DJ-	" " " ABACV20K3	1700	"	"
" DK-DL-DM-DN-DR-DS-	" " " BCACV20K3	"	"	"
" DT-DU-DV-DW-DX-DY	" " " ABACV20L2	1800	"	"
" 276 -B	" " " BCACV20L2	"	"	"
" 277 -B	" " " ABACV20L3	1700	"	"
" 280 -B-C-D-E-G-H-K-L-M-N-	" " " ABACV20L2	1800	"	"
" P-R-S-S-T-U-J	" " " ABACV20L3	1700	"	"
" 281 -B	" " " BCACV20L3	"	"	"
" 282 -B	" " " ABABL20K1	1600	"	"
" 285 -B-C-D-E-G-H-J-K-L-M-N	" " " ABABL20K2	1400	"	"
" 287 -B-C-D	" " " BCABL20K2	1500	"	"
" 292 -B-C-D-E-G-H-J-K-L-M-	" " " BNABL20K2	"	"	"
" N-P-R-S-T-U-V-W-X	" " " ABABL20K3	1300	"	"
" 293 -B-C-D	" " " BCABL10K3	"	"	"
" 296 -B-C-D-E-G-H-J-K-L-M-	" " " ABABL20L2	"	"	"
" N-P-R-S-T-U-V-W-X	" " " BCABL20L2	1400	"	"
" 298 -B-C-D	" " " ABABL20L3	1200	"	"
" 299 -B-C-D	" " " BCABL20L3	"	"	"
" 302 -B-C-D-E-G-H-J-K-L-M-	" " " ABAAB20K1	1900	"	"
" N-P-R-S-T-U-V-W-X-Y-Z-	" " " ABAAB20K2	1800	"	"
" BB-BC-BD-BE-BG-BH-BJ-BK-	" " " BCAAB20K2	1700	"	"
" BL-BM-BN-BP-BR-BS-BT-BU-	" " " BCAAB20K2	1700	"	"
" BV-BW-BX-BY-BZ-CB	" " " BCAAB20K2	1700	"	"
" 303 -B-C-D	" " " BCAAB20K2	1700	"	"
" 304 -B-C-D	" " " BCAAB20K2	1700	"	"
" 307 -B-C-D-E-G-H-J-K-L-M-	" " " BCAAB20K2	1700	"	"
" N-P-R-S-T-U-V-W-X-Y-Z-	" " " BCAAB20K2	1700	"	"
" BB-BC-BD-BE-BG-BH-BJ-BK-	" " " BCAAB20K2	1700	"	"
" BL-BM-BN-BP	" " " BCAAB20K2	1700	"	"
" 310 -B-C-D-E-G-H-J	" " " BCAAB20K2	1700	"	"
" 315 -B-C-D-E-G-H-J-K-L-M-	" " " BCAAB20K2	1700	"	"
" N-P-R-S-T-U-V-W-X-Y-Z-	" " " BCAAB20K2	1700	"	"
" BB-BC-BD-BE-BG-BH-BJ-BK-	" " " BCAAB20K2	1700	"	"
" BL-BM-BN-BP-BR-BS-BT-BU-	" " " BCAAB20K2	1700	"	"
" BV-BX-BY-BZ-CB-CC-CD-CE-	" " " BCAAB20K2	1700	"	"
" CG-CH-CJ-CK-CL	" " " BCAAB20K2	1700	"	"
" 316 -B-C-D-E-G-H-J	" " " BCAAB20K2	1700	"	"
" 319 -B-C-D-E-G-H-J-K-L-M-N-	" " " BCAAB20K2	1700	"	"
" P-R-S-T-U-V-W-X-Y-Z-BB-	" " " BCAAB20K2	1700	"	"
" BC-BD-BE-BG-BH-BJ-BK-BL-	" " " BCAAB20K2	1700	"	"
" BM-BN-BP-BR-BS-BT-BU-BV-	" " " BCAAB20K2	1700	"	"
" BW-BX-BY-BZ-CB-CC-CD-CE-	" " " BCAAB20K2	1700	"	"
" CG-CH-CJ-CK-CL	" " " BCAAB20K2	1700	"	"
" 322 -B-C-D	" " " BCAAB20K2	1700	"	"
" 323 -B-C-D	" " " BCAAB20K2	1700	"	"
" 326 -B-C-D-E-G-H-J-K-L-M-N-	" " " BCAAB20K2	1700	"	"
" P-R-S-T-U-V-W-X-Y-Z-BB-	" " " BCAAB20K2	1700	"	"
" BC-BD-BE-BG-BH-BJ-BK-BL-	" " " BCAAB20K2	1700	"	"
" BM-BN-BP	" " " BCAAB20K2	1700	"	"





DISPOSITIVO DI TRAINO TIPO 43033  
PER AUTOVEICOLI VW TRANSPORTER "90"

ANNO 1992

S. SISTO - PG

PER LE SINGOLE VERSIONI E RELATIVI PESI E LARGHEZZE  
RIMORCHIABILI VEDERE LA TABELLA ALLEGATA

PAG. 2/4

marchio di convalida

MINISTERO DEI TRASPORTI C. S. R. P. A. D. DI ROMA  
APPROVAZIONE AI SENSI DELLA CIRC. MIN. 20/76 DEL 21.06.76

ESTREMI D'IDENTIFICAZIONE  
RIPORTATI SU APPOSITA  
TARGHETTA

VERBALE N° 021/92/RM DEL 09.01.92

5° AGGIORNAMENTO PER INTRODUZIONE NUOVE VERSIONI

TABELLA MASSE RIMORCHIABILI

OM	VERSIONI E MODELLI	MASSA RIMORCHIABILE	LARGHEZZA MAX RIMORCH.LE	CARICO STATICO SU SFERA
		KG	MT	KG
52598				
EST 326BR-B-S-BT-BU-BV-BW-BX-BY-BZ-CB	70 VERS. X0. BCAAB20K2	1900	2,50	100
" 327 -B-C-D	" " " BNAAB20K2	"	"	"
" 328 -B-C-D	" " " ABAAB20K3	1700	"	"
" 331 -B-C-D-E-G-H-J-K-L-M-N-P-R-S-T-U-V-W-X-Y-Z-BB-BC-BD-BE-BG-BH-BJ-BK-BL-BM-BN-BP	" " " BCAAB20K3	"	"	"
" 334 -B-C-D-E-G-H-J	" " " ABAAB20L2	1800	"	"
" 339 -B-C-D-E-G-H-J-K-L-M-N	" " " BCAAB20L2	1700	"	"
" 339P-R-S-T-U-V-W-X-Y-Z-BB-BC-BD-BE-BG-BH-BJ-BK-BL-BM-BN-BP-BR-BS-BT-BU-BV-BW-BX-BY-BZ-CB-CC-CD-CE-CG-CH-CJ-CK-CL	" " " " " " "	1800	"	"
" 340 -B-C-D-E-G-H-J	" " " ABAAB20L3	1700	"	"
" 343 -B-C-D-E-G-H-J-K-L-M-N-P-R-S-T-U-V-W-X-Y-Z-BB-BC-BD-BE-BG-BH-BJ-BK-BL-BM-BN-BP-BR-BS-BT-BU-BV-BW-BX-BY-BZ-CB-CC-CD-CE-CG-CH-CJ-CK-CL	" " " BCAAB20L3	"	"	"
" 346 -B	" " X1 ABAAB20K1	1800	"	"
" 349 -B-C-D-E	" " " BCAAB20K1	1700	"	"
" 349G-H-J-K-L-M-N-P-R-S-T-U	" " " " " " "	1800	"	"
" 349V-W-X-Y-Z	" " " " " " "	1900	"	"
" 350 -B	" " " BNAAB20K1	"	"	"
" 351 -B	" " " ABAAB20K2	1700	"	"
" 354 -B-C-D-E-G-H-J-K-L-M-N-P-R-S-T-U	" " " BCAAB20K2	"	"	"
" 355 -B	" " " ABAAB20L1	1800	"	"
" 355C-D	" " " " " " "	1700	"	"
" 360 -B-C-D-E-G-H-J-K-L-M-N-P-R-S-T-U-V-W-X-Y-Z-BB-BC-BD-BE	" " " BCAAB20L1	1800	"	"
" 361 -B-C-D	" " " ABAAB20L2	1700	"	"
" 364 -B-C-D-E-G-H-J-K-L-M-N-P-R-S-T-U-V-W-X-Y-Z-BB-BC-BD-BE	" " " BCAAB20L2	"	"	"
" 365 -B	" " X0 ABACV20K1	1900	"	"
" 366 -B	" " " ABACV20K2	1800	"	"
" 369 -B-C-D-E	" " " BCACV20K2	1700	"	"
" 369G-H-J-K-L-M-N-P-R-S-T-U	" " " " " " "	1800	"	"
" 369V-W-X-Y-Z	" " " " " " "	1900	"	"
" 370 -B	" " " BNACV20K2	"	"	"
" 371 -B	" " " ABACV20K3	1700	"	"
" 374 -B-C-D-E-G-H-J-K-L-M-N-P-R-S-T-U	" " " BCACV20K3	"	"	"
" 377 -B-C-D	" " " ABACV20L2	"	"	"
" 382 -B-C-D-E-G-H-J-K-L-M-N-P-R-S-T-U-V-W-X-Y-Z-BB-BC-BD-BE	" " " BCACV20L2	1800	"	"
" 383 -B-C-D	" " " ABACV20L3	1700	"	"
" 386 -B-C-D-E-G-H-J-K-L-M-N-P-R-S-T-U-V-W-X-Y-Z-BB-BC-BD-BE	" " " BCACV20L3	"	"	"
" 389 -B	" " " ABAAC20K1	1600	"	"
" 390 -B	" " " ABAAC20K2	1400	"	"
" 393 -B-C-D-E-G-H-J-K-L-M-N-P-R-S-T-U-V-W-X-Y-Z	" " " BCAAC20K2	1500	"	"
" 394 -B	" " " BNAAC20K2	"	"	"





DISPOSITIVO DI TRAINO TIPO 43033  
PER AUTOVEICOLI VW TRANSPORTER "90"

ANNO 1992

S. SISTO - PG

marchio di convalida

PER LE SINGOLE VERSIONI E RELATIVI PESI E LARGHEZZE  
RIMORCHIABILI VEDERE LA TABELLA ALLEGATA

PAG. 3/4

MINISTERO DEI TRASPORTI C. S. R. P. A. D. DI ROMA  
APPROVAZIONE AI SENSI DELLA CIRC. MIN. 20/76 DEL 21-06-76

ESTREMI D'IDENTIFICAZIONE  
RIPORTATI SU APPOSITA  
TARGHETTA.

VERBALE N° 021/92/RM DEL 09.01.92

5° AGGIORNAMENTO PER INTRODUZIONE NUOVE VERSIONI

TABELLA MASSE RIMORCHIABILI

OM	VERSIONI E MODELLI	MASSA RIMORCHIABILE	LARGHEZZA MAX RIMORCHIE	CARICO STATICO SU SFERA
		KG	-MT	KG
52598	70 VERS. X0 ABAAB20L1	1300	2.50	100
EST 395 -B	" " " BCAAC20K3	"	"	"
" 398 -B-C-D-E-G-H-J-K-L-M-N	" " " ABAAC20L2	"	"	"
" P-R-S-T-U	" " " BCAAC20L2	1400	"	"
" 401 -B-C-D	" " " ABAAC20L3	1200	"	"
" 406 -B-C-D-E-G-H-J-K-L-M-N	" " " BCAAC20L3	"	"	"
" P-R-S-T-U-V-W-X-Y-Z-BB-	" " " ABACU20K2	1700	"	"
" BC-BD-BE	" " " BCACU20K2	1900	"	"
" 407 -B-C-D	" " " BNACU20K2	"	"	"
" 410 -B-C-D-E-G-H-J-K-L-M-N	" " " ABACU20K3	1700	"	"
" P-R-S-T-U-V-W-X-Y-Z-BB-	" " " BCACU20K3	"	"	"
" BC-BD-BE	" " " ABACU20L2	1800	"	"
" 413 -B	" " " BCACU20L2	1700	"	"
" 416 -B-C-D-E-G-H-J-K-L-M-N	" " " ABACU20L3	1700	"	"
" P-R-S-T-U	" " " BCACU40K2	"	"	"
" 416V-W-X-Y-Z	" " " BNACU40K2	"	"	"
" 417 -B	" " " ABACU40K3	1800	"	"
" 418 -B	" " " BCACU40K3	1700	"	"
" 421 -B-C-D-E-G-H-J-K-L-M-N	" " " ABACU40L2	1800	"	"
" P-R-S-T-U	" " " BCACU40L3	1700	"	"
" 424 -B-C-D	" " " ABACU20L3	"	"	"
" 429 -B-C-D-E-G	" " " ABACU40K2	1900	"	"
" 429H-J-K-L-M-N-P-R-S-T-U-V-	" " " BCACU40K2	"	"	"
" W-X-Y-Z-BB-BC-BD-BE	" " " ABACU40K3	1800	"	"
" 430 -B-C-D	" " " BCACU40K3	1700	"	"
" 433 -B-C-D-E-G-H-J-K-L-M-N	" " " ABACU40L2	1800	"	"
" P-R-S-T-U-V-W-X-Y-Z-BB-	" " " BCACU40L3	"	"	"
" BC-BD-BE	" " " ABACU40K2	1700	"	"
" 436 -B	" " " BNACU40K2	"	"	"
" 438 -B-C-D-E	" " " ABACU40K3	1800	"	"
" 438G-H-J-K-L-M-N-P-R-S-T-U	" " " BCACU40K3	1700	"	"
" 438V-W-X-Y-Z	" " " ABACU40L2	1800	"	"
" 439 -B	" " " BCACU40L3	1700	"	"
" 440 -B	" " " ABACU20K1	1700	"	"
" 442 -B-C-D-E-G-H-J-K-L-M-N	" " " BCACU20K1	1800	"	"
" P-R-S-T-U	" " " BCACU20K2	1800	"	"
" 445 -B-C-D	" " " ABACU20L1	"	"	"
" 447 -B-C-D-E-G-H-J-K-L-M-N	" " " BCACU20L1	"	"	"
" P-R-S-T-U-V-W-X-Y-Z-BB-	" " " BCACU20L2	"	"	"
" BC-BD-BE	" " " ABACU20L2	1700	"	"
" 448 -B-C-D	" " " BCACU20L3	"	"	"
" 450 -B-C-D-E-G-H-J-K-L-M-N	" " " ABACU20K1	1800	"	"
" P-R-S-T-U-V-W-X-Y-Z-BB-	" " " BCACU20K1	1700	"	"
" BC-BD-BE	" " " BCACU20K2	1800	"	"
" 453 -B	" " " ABACU20L1	"	"	"
" 456 -B-C-D-E	" " " BCACU20L2	1700	"	"
" 456G-H-J-K-L-M-N-P-R-S-T-U	" " " BCACU20L3	"	"	"
" 456V-W-X-Y-Z	" " " ABACU20K1	1800	"	"
" 457 -B	" " " BCACU20K2	1900	"	"
" 458 -B	" " " ABACU20K3	1700	"	"
" 461 -B-C-D-E-G-H-J-K-L-M-N	" " " BCACU20K3	"	"	"
" P-R-S-T-U	" " " ABACU20L1	1800	"	"
" 462 -B-C-D	" " " BCACU20L2	"	"	"
" 467 -B-C-D-E-G-H-J-K-L-M-N	" " " ABACU20L3	"	"	"
" P-R-S-T-U-V-W-X-Y-Z-BB-	" " " BCACU20L1	"	"	"
" BC-BD-BE	" " " ABACU20L2	1700	"	"
" 468 -B-C-D	" " " BCACU20L3	"	"	"
" 471 -B-C-D-E-G-H-J-K-L-M-N	" " " ABACU20K1	"	"	"
" P-R-S-T-U-V-W-X-Y-Z-BB-	" " " BCACU20K2	"	"	"
" BC-BD-BE	" " " ABACU20K3	"	"	"
" 473 -B-C-D-E-G-H-J-K-L-M	" " " BCACU20K3	"	"	"
" 473N-P-R-S-T-U	" " " ABACU20K3	1800	"	"

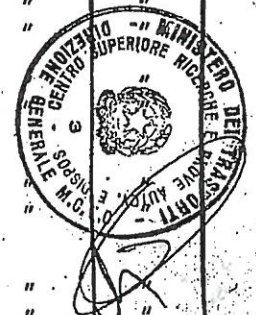



DISPOSITIVO DI TRAINO TIPO 43033  
PER AUTOVEICOLI VW TRANSPORTER "90"

ANNO 1992

S. SISTO - PG

PER LE SINGOLE VERSIONI E RELATIVI PESI E LARGHEZZE  
RIMORCHIABILI VEDERE LA TABELLA ALLEGATA

PAG. 4/4

marchio di convalida

MINISTERO DEI TRASPORTI C. S. R. P. A. D. DI ROMA  
APPROVAZIONE AI SENSI DELLA CIRC. MIN. 20/76 DEL 21-06-76

ESTREMI D'IDENTIFICAZIONE  
RIPORTATI SU APPOSITA  
TARGHETTA

VERBALE N° 021/92/RM DEL 09.01.92

5° AGGIORNAMENTO PER INTRODUZIONE NUOVE VERSIONI

TABELLA MASSE RIMORCHIABILI

OM	VERSIONI E MODELLI	MASSA RIMORCHIABILE	LARGHEZZA MAX RIMORCHIE	CARICO STATICO SU SFERA
		KG	MT	KG
52598	70 VERS. X0 BCAES20K2	1900	2,50	100
EST 473V-W-X-Y-Z	" " " BNAES20K2	"	"	"
" 474 -B	" " " BCAES20K3	1700	"	"
" 476 -B-C-D-E-G-H-J-K-L-M-N-P-R-S-T-U	" " " BCAES20L2	1800	"	"
" 480 -B-C-D-E-G-H-J-K-L-M-N-P-R-S-T-U-V-W-X	" " " BCAES20L3	1700	"	"
" 482 -B-C-D-E-G-H-J-K-L-M-N-P-R-S-T-U-V-W-X	" " " BCAES40K2	"	"	"
" 486 -B-C-D-E-G-H-J-K-L	" " " BNAES40K2	1800	"	"
" 486M-N-P-R-S-T-U-V-W-X-Y-Z	" " " BCAES40K3	1900	"	"
BB-BC-BD-BE-BG-BH-BJ-BK	" " " BCAES40K3	1700	"	"
BL-BM-BN-BP-BR-BS-BT-BU	" " " BCAES40L2	1800	"	"
BV-BW-BX-BY-NZ-CB	" " " BCAES40L3	1700	"	"
" 487 -B-C-D				
" 489 -B-C-D-E-G-H-J-K-L-M-N-P-R-S-T-U-V-W-X-Y-Z-BB-BC-BD-BE-BG-BH-BJ-BK-BL-BM-BN-BP				
" 493 -B-C-D-E-G-H-J-K-L-M-N-P-R-S-T-U-V-W-X-Y-Z-BB-BC-BD-BE-BG-BH-BJ-BK-BL-BM-BN-BP-BR-BS-BT-BU-BV-BW				
" 495 -B-C-D-E-G-H-J-K-L-M-N-P-R-S-T-U-V-W-X-Y-Z-BB-BC-BD-BE-BG-BH-BJ-BK-BL-BM-BN-BP-BR-BS-BT-BU-BV-BW				

Prot. 1737 del 19 MAR. 1996  
operazione ESTR 082955  
agli autoveicoli sopra indicati  
può essere applicata la struttura  
di traino approvata con verbale  
n° 021/92/RM del 09-01-92  
C. S. R. P. A. D. DI ROMA

IL DIRETTORE

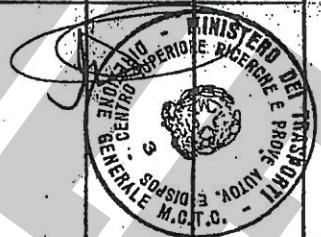

Imposta di bollo  
assolta mediante  
versamento in c/c  
postale ai sensi  
dell'art. 7 della  
legge 18-10-78,  
n° 625





**DISPOSITIVO DI TRAINO TIPO 43033  
PER AUTOVEICOLI VW TRANSPORTER "90" FURG.**

ANNO 1992

s.r.l. S. 5150 - PG

marchio di convalida

PER LE SINGOLE VERSIONI E RELATIVI PESI E LARGHEZZE  
RIMORCHIABILI VEDERE LA TABELLA ALLEGATA

PAG. 1/3

MINISTERO DEI TRASPORTI C. S. R. P. A. D. DI ROMA  
APPROVAZIONE AI SENSI DELLA CIRC. MIN. 20/76 DEL 21.06.76

ESTREMI D'IDENTIFICAZIONE  
RIPORTATI SU APPOSITA  
TARGHETTA

VERBALE N° 021/92/RM DEL 09.01.92

4° AGGIORNAMENTO PER INTRODUZIONE NUOVE VERSIONI

TABELLA MASSE RIMORCHIABILI

OM	VERSIONI E MODELLI	MASSA RIMORCHIABILE	LARGHEZZA MAX RIMORCHIE	CARICO STATICO SU SFERA
		KG	MT	KG
52598				
EST 38K-L-M-N-P-R-S-T	70 VERS. X0 AB 1X20L2	1700	2.50	100
" 39K-L-M-N-P-R-S-T	AB 1X20L2A	"	"	"
" 44CU-CV-CW-CX-CY-CZ-DB-DC- DD-DE-DG-DH-DJ-DK-DL-DM- DN-DP-DR-DS-DT-DU-DV-DW- DX-DY-DZ-EB	BC 1X20L2	"	"	"
" 45BD-BE-BG-BH-BJ-BK-BL-BM	AB AAC20L2	"	"	"
" 46BD-BE-BG-BH-BJ-BK-BL-BM	AB AAC20L2A	"	"	"
" 51KH-KJ-KK-KL-KM-KN-KP-KR- KS-KT-KU-KW-KX-KY-KZ-LB- LC-LD-LE-LG-LH-LJ-LK-LL- LM-LN-LP	BC AAC20L2	"	"	"
" 52U-V-W-X-Y-Z-BB-BC	AB AAB20L2	"	"	"
" 53U-V-W-X-Y-Z-BB-BC	AB AAB20L2A	"	"	"
" 60GN-GP-GR-GS-GT-GU-GV-GW- GX-GY-GZ-HB-HC-HD-HE-HG- HH-HJ-HK-HL-HM-HN-HP-HR- HS-HT-HU-HV	BC AAB20L2	"	"	"
" 61U-V-W-X-Y-Z-BB-BC	AB AAF20L2	"	"	"
" 62U-V-W-X-Y-Z-BB-BC	AB AAF20L2A	"	"	"
" 69GN-GP-GR-GS-GT-GU-GV-GW- GX-GY-GZ-HB-HC-HD-HE-HG- HH-HJ-HK-HL-HM-HN-HP-HR- HS-HT-HU-HV	BC AAF20L2	"	"	"
" 70K-L-M-N-P-R-S-T	AB 1X20L3	"	"	"
" 73CS-CT-CU-CV-CW-CX-CY-CZ- DB-DC-DD-DE-DG-DH-DJ-DK- DL-DM-DN-DP-DR-DS-DT-DU- DV-DW-DX-DY	BC 1X20L3	"	"	"
" 74BD-BE-BG-BH-BJ-BK-BL-BM	AB AAC20L3	"	"	"
" 75JZ-KB-KC-KD-KE-KG-KH-KJ- KK-KL-KM-KN-KP-KR-KS-KT- KU-KV-KW-KX-KY-KZ-LB-LC- LD-LE-LG-LH	BC AAC20L3	"	"	"
" 78U-V-W-X-Y-Z-BB-BC	AB AAB20L3	"	"	"
" 81GH-GJ-GK-GL-GM-GN-GP-GR- GS-GT-GU-GV-GW-GX-GY-GZ- HB-HC-HD-HE-HG-HH-HJ-HK- HL-HM-HN-HP	BC AAB20L3	"	"	"
" 82U-V-W-X-Y-Z-BB-BC	AB AAF20L3	"	"	"
" 85GH-GJ-GK-GL-GM-GN-GP-GR- GS-GT-GU-GV-GW-GX-GY-GZ- HB-HC-HD-HE-HG-HH-HJ-HK- HL-HM-HN-HP	BC AAF20L3	"	"	"
" 108K-L-M-N-P-R-S-T	AB ABL20L2	1400	"	75
" 109K-L-M-N-P-R-S-T	AB ABL20L2A	"	"	"
" 110K-L-M-N-P-R-S-T	AB ABL20L3	1250	"	"
" 117CU-CV-CW-CX-CY-CZ-DB-DC- DD-DE-DG-DH-DJ-DK-DL-DM- DN-DP-DR-DS-DT-DU-DV-DW- DX-DY-DZ-EB	BC ABL20L2	1500	"	"
" 118CS-CT-CU-CV-CW-CX-CY-CZ- DB-DC-DD-DE-DG-DH-DJ-DK- DL-DM-DN-DP-DR-DS-DT-DU- DV-DW-DX-DY	BC ABL20L3			
" 183 -B-C-D-E-G-H-J	AB AAB41K2			
" 185 -B-C-D-E-G-H-J-K-L-M-N- P-R-S-T-U-V-W-X-Y-Z-BB- BC-BD-BE-BG	BC AAB41K2			
" 186 -B	BN AAB41K2			





**DISPOSITIVO DI TRAINO TIPO 43033  
PER AUTOVEICOLI  
VW TRANSPORTER "90" FURG.**

ANNO 1992

S. SISTO - PG

PER LE SINGOLE VERSIONI E RELATIVI PESI E LARGHEZZE  
RIMORCHIABILI VEDERE LA TABELLA ALLEGATA

PAG. 2/3

marchio di convalida

MINISTERO DEI TRASPORTI C. S. R. P. A. D. DI ROMA  
APPROVAZIONE AI SENSI DELLA CIRC. MIN. 20/76 DEL 21-06-76

ESTREMI D'IDENTIFICAZIONE  
RIPORTATI SU APPOSITA  
TARGHETTA

VERBALE N° 021/92/RM DEL 09.01.92

**4° AGGIORNAMENTO**

**TABELLA MASSE RIMORCHIABILI**

OM	VERSIONI E MODELLI	MASSA RIMORCHIABILE	LARGHEZZA MAX RIMORCHIE	CARICO STATICO SU SFERA
		KG	-MT	KG
52598				
EST 187	-B-C-D-E-G-H-J	70 VERS. X0 AB AAB20L3	1750	100
" 189	-B-C-D-E-G-H-J-K-L	BC AAB41K3	1700	"
" 190	-B-C-D-E-G-H-J-K-L-M-N-P-R-S-T	AB AAB41L2	2000	"
" 192	-B-C-D-E-G-H-J-K-L-M-N-P-R-S-T-U-V-W-X-Y-Z-BB-BC-BD-BE-BG	BC AAB41L2	1850	"
" 193	-B-C-D-E-G-H-J-K-L-M-N-P-R-S-T	AB AAB41L3	1750	"
" 195	-B-C-D-E-G-H-J-K-L-M-N-P-R-S-T-U-V-W-X-Y-Z-BB-BC-BD-BE	BC AAB41L3	1700	"
" 196	-B-C-D-E-G-H-J	AB AAF41K2	2000	"
" 198	-B-C-D-E-G-H-J-K-L-M-N-P-R-S-T-U-V-W-X-Y-Z-BB-BC-BD-BE-BG	BC AAF41K2	1900	"
" 199	-B	BN AAF41K2	2000	"
" 200	-B-C-D-E-G-H-J	AB AAF41K3	1750	"
" 202	-B-C-D-E-G-H-J-K-L	BC AAF41K3	1700	"
" 203	-B-C-D-E-G-H-J-K-L-M-N-P-R-S-T	AB AAF41L2	2000	"
" 205	-B-C-D-E-G-H-J-K-L-M-N-P-R-S-T-U-V-W-X-Y-Z-BB-BC-BD-BE-BG	BC AAF41L2	1850	"
" 206	-B-C-D-E-G-H-J-K-L-M-N-R-S-T	AB AAF41L3	1750	"
" 208	-B-C-D-E-G-H-J-K-L-M-N-R-S-T-U-V-W-X-Y-Z-BB-BC-BD-BE	BC AAF41L3	1700	"
" 209	-B-C-D-E-G-H-J	AB ACU20K2	1600	75
" 211	-B-C-D-E	BC ACU20K2	"	"
" 212	-B	BN ACU20K2	"	"
" 213	-B-C-D-E-G-H-J	AB ACU20K3	1700	100
" 215	-B-C-D-E-G-H-J-K-L-M-N	BC ACU20K3	"	"
" 216	-B-C-D-E-G-H-J-K-L-M-N-P-R-S-T	AB ACU20L2	"	"
" 218		BC ACU20L2	"	"
" 219	-B-C-D-E-G-H-J-K-L-M-N-P-R-S-T	AB ACU20L3	"	"
" 221	-B-C-D-E-G-H-J-K-L-M-N-P-R	BC ACU20L3	"	"
" 222	-B-C-D	AB ACU40K2	2000	"
" 224	-B-C-D-E	BC ACU40K2	1900	"
" 225	-B	BN ACU40K2	2000	"
" 226	-B-C-D	AB ACU40K3	1750	"
" 228	-B-C-D-E-G-H-J-K-L-M-N	BC ACU40K3	1700	"
" 229	-B-C-D-E-G-H-J	AB ACU40L2	2000	"
" 231		BC ACU40L2	1850	"
" 232	-B-C-D-E-G-H-J	AB ACU40L3	1750	"
" 234	-B-C-D-E-G-H-J-K-L-M-N-P-R	BC ACU40L3	1700	"
" 235	-B-C-D-E-G-H-J	AB ACU20K1	2000	"
" 237	-B-C-D-E	BC ACU20K1	1950	"
" 238	-B	BN ACU20K1	2000	"
" 239	-B-C-D-E-G-H-J	AB ACU20K2	1750	"
" 241	-B-C-D-E-G-H-J-K-L-M-N	BC ACU20K2	"	"
" 242	-B-C-D-E-G-H-J-K-L-M-N-P-R-S-T	AB ACU20L1	2000	"
" 244		BC ACU20L1	1900	"
" 245	-B-C-D-E-G-H-J-K-L-M-N-P-R-S-T	AB ACU20L2	1750	"
" 247	-B-C-D-E-G-H-J-K-L-M-N-P-R	BC ACU20L2	1700	"
		70 VERS. X1		





**DISPOSITIVO DI TRAINO TIPO 43033  
PER AUTOVEICOLI VW TRANSPORTER "90" FURG.**

ANNO 1992

s.r.l. S. SISTO - PG

PER LE SINGOLE VERSIONI E RELATIVI PESI E LARGHEZZE RIMORCHIABILI VEDERE LA TABELLA ALLEGATA

PAG. 3/3

MINISTERO DEI TRASPORTI C. S. R. P. A. D. DI ROMA  
APPROVAZIONE AI SENSI DELLA CIRC. MIN. 20/76 DEL 21-06-76

VERBALE N° 021/92/RM DEL 09.01.92

ESTREMI D'IDENTIFICAZIONE  
RIPORTATI SU APPOSITA  
TARGHETTA

4° AGGIORNAMENTO PER INTRODUZIONE NUOVE VERSIONI

TABELLA MASSE RIMORCHIABILI

OM	VERSIONI E MODELLI	MASSA RIMORCHIABILE KG	LARGHEZZA MAX RIMORCHIE MT	CARICO STATICO SU SFERA KG
52598	70 VERS. XO BC ACU 20K2			
EST 211G-H-J-K-L-M-N-P-R-S-T-U-V-W-X-Y-Z-BB-BC-BD-BE-BG-BH-BJ	" " " BC ACU 20K3	1600	2.50	75
" 215P-R-S-T-U-V-W-X-Y-Z	" " " BC ACU 20K3	1700	"	100
" 218B-C-D-E-G-H-J-K-L-M-N-P-R-S-T-U-V-W-X-Y-Z-BB-BC-BD-BE-BG-BH-BJ-BK-BL-BM-BN-BP-BR-BS-BT-BU-BV	" " " BC ACU 20L2	"	"	"
" 221S-T-U-V-W-X-Y-Z-BB-BC-BD-BE-BG-BH-BJ-BK-BL-BM-BN-BP-BR-BS-BT-BU	" " " BC ACU 20L3	"	"	"
" 222E-G-H-J	" " " AB ACU 40K2	2000	"	"
" 224G-H-J-K-L-M-N-P-R-S-T-U-V-W-X-Y-Z-BB-BC-BD-BE-BG-BH-BJ	" " " BC ACU 40K2	1900	"	"
" 226E-G-H-J	" " " AB ACU 40K3	1750	"	"
" 228P-R-S-T-U-V-W-X-Y-Z	" " " BC ACU 40K3	1700	"	"
" 229K-L-M-N-P-R-S-T	" " " AB ACU 40L2	2000	"	"
" 231B-C-D-E-G-H-J-K-L-M-N-P-R-S-T-U-V-W-X-Y-Z-BB-BC-BD-BE-BG	" " " BC ACU 40L2	1850	"	"
" 232K-L-M-N-P-R-S-T	" " " AB ACU 40L3	1750	"	"
" 234S-T-U-V-W-X-Y-Z-BB-BC-BD-BE	" " " BC ACU 40L3	1700	"	"
" 237G-H-J-K-L-M-N-P-R-S-T-U-V-W-X-Y-Z-BB-BC-BD-BE-BG-BH-BJ	" " X1 BC ACU 20K1	1950	"	"
" 241P-R-S-T-U-V-W-X-Y-Z	" " " BC ACU 20K2	1750	"	"
" 244B-C-D-E-G-H-J-K-L-M-N-P-R-S-T-U-V-W-X-Y-Z-BB-BC-BD-BE-BG-BH-BJ-BK-BL-BM-BN-BP-BR-BS-BT-BU-BV	" " " BC ACU 20L1	1900	"	"
" 247S-T-U-V-W-X-Y-Z-BB-BC-BD-BE-BG-BH-BJ-BK-BL-BM-BN-BP-BR-BS-BT-BU	" " " BC ACU 20L2	1700	"	"

Prot. 2274 del 13 APR. 1995  
operazione 25/1/08/1994  
e il autoveicoli sopra indicati  
può essere applicata la struttura  
di traino approvata con verbale  
n. 021/92/RM del 09-01-92  
C. S. R. P. A. D. di ROMA

Imposta di bollo  
assolta mediante  
versamento in c/c  
postale ai sensi  
dell'art. 7 della  
legge 18-10-78,  
n° 625





COD.: 43033

TIMBRO A SECCO .

UMBRA GANCI S.r.l. Str. Torretta 06080 S.SISTO (PG) Tel. 075/787033

CERTIFICATO DI ORIGINE DI UN DISPOSITIVO DI TRAINO

"UMBRA GANCI"

Si certifica che il dispositivo di traino, illustrato sul retro, è identificabile con apposita targhetta posta vicino al gancio a sfera, riportante il marchio di fabbrica, il N° di approvazione M.C.T.C. ed il modello della vettura, è stato costruito dalla Società "UMBRA GANCI" che si assume la responsabilità delle saldature e delle lavorazioni fattevi. Tale dispositivo è conforme alle Circolari Ministeriali N° 2195/2203-6 del 5/7/1967 e successive, nonché alle tabelle CUNA NC 438-09 del 23/9/68; NC 138610 dell'Ottobre 1968 - NC 165-30 e successive.

Per i dispositivi approvati dopo il 31.10.1978 gli stessi rispondono alla circolare 20 del 21/06/76 e successive e tabelle CUNA NC 138-30-40, NC 438-40 e successive.

"Il presente certificato, che viene ritirato in SEDE DI COLLAUDO, ha validità unicamente se convalidato con marchio UMBRA GANCI stampigliato a secco".

DICHIARAZIONE DI RESPONSABILITA' PER IL MONTAGGIO:

Si dichiara che il presente dispositivo di traino tipo ..... è stato montato a regola d'arte, rispettando le prescrizioni fornite dalla casa costruttrice, sull'autoveicolo mod. .... targa .....

IN FEDE

(Timbro e firma)

# MECCANISMO MOD. C 2007

tel. +39 075 5280260  
 fax +39 075 5287033  
[www.umbrarimorchi.it](http://www.umbrarimorchi.it)  
[umbrarimorchi@umbrarimorchi.it](mailto:umbrarimorchi@umbrarimorchi.it)



<b>NL - Montage</b>	<b>S - Montering</b>	<b>I - Montaggio</b>
<b>GB - Mounting</b>	<b>DK - Tilkobling</b>	
<b>D - Montage</b>	<b>FIN - Aseennus</b>	
<b>F - Montage</b>	<b>E - Montaje</b>	

<b>NL - Demontage</b>	<b>S - Demontering</b>	<b>I - Smontaggio</b>
<b>GB - Disounting</b>	<b>DK - Frakobling</b>	
<b>D - Demontage</b>	<b>FIN - Irrotta</b>	
<b>F - Démontage</b>	<b>E - Desmontaje</b>	

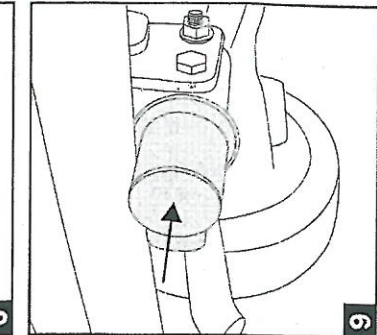
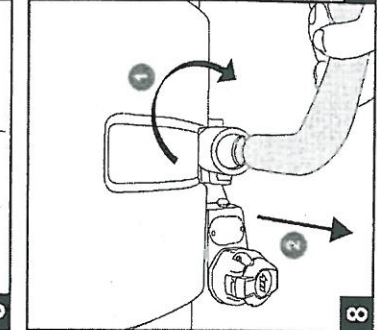
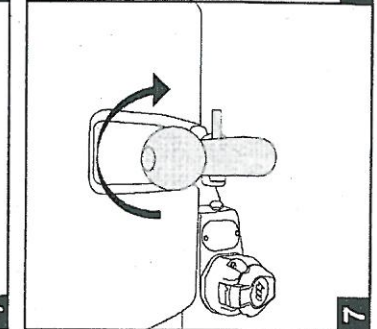
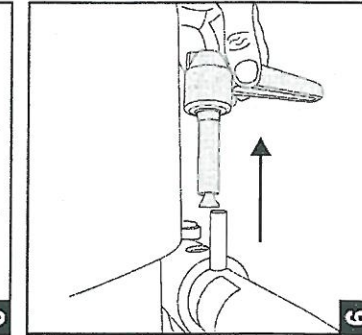
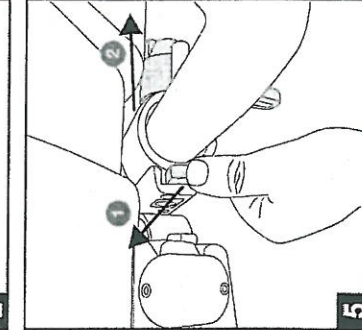
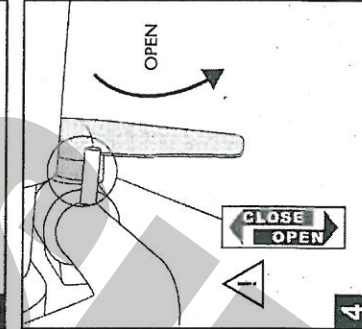
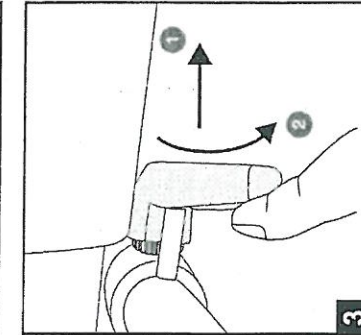
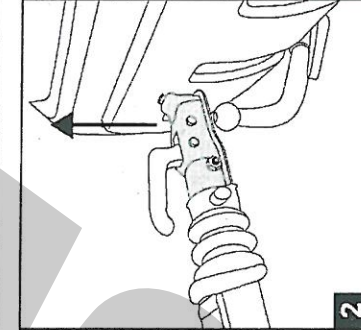
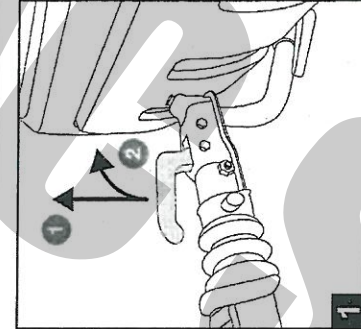
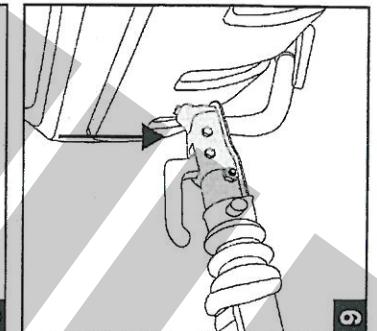
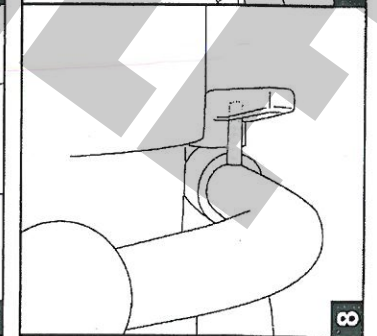
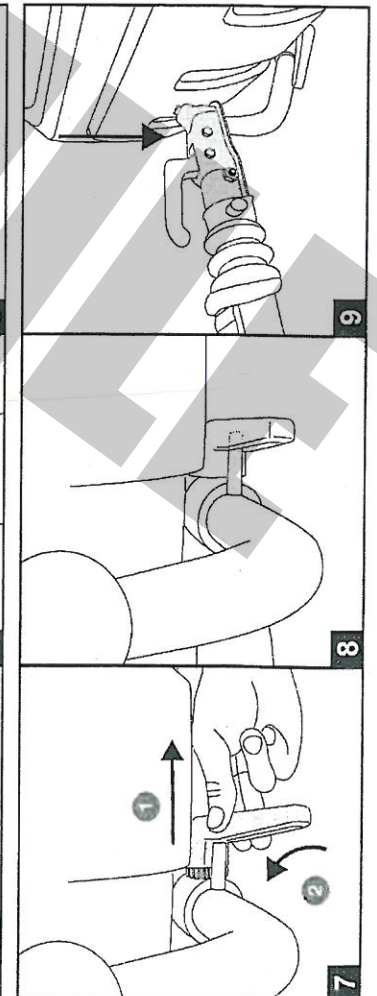
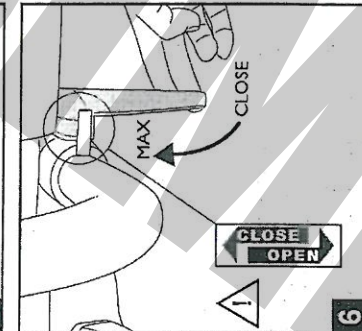
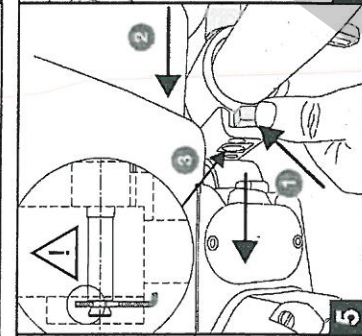
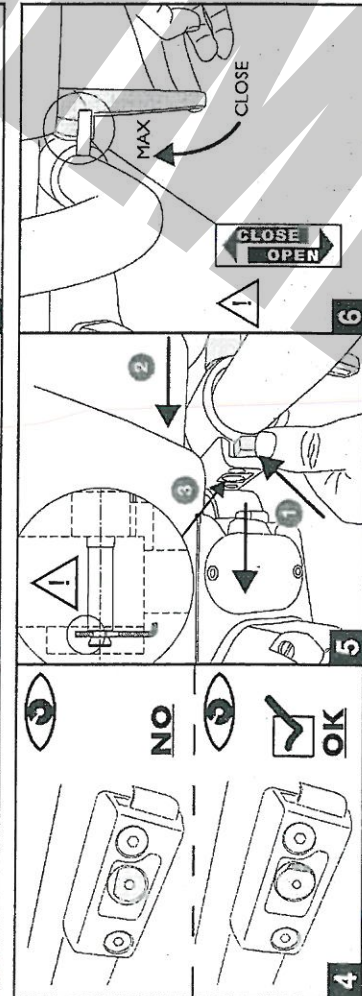
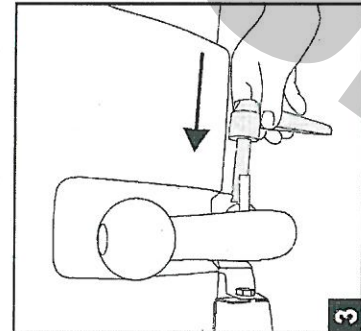
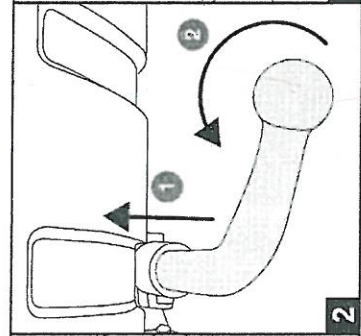
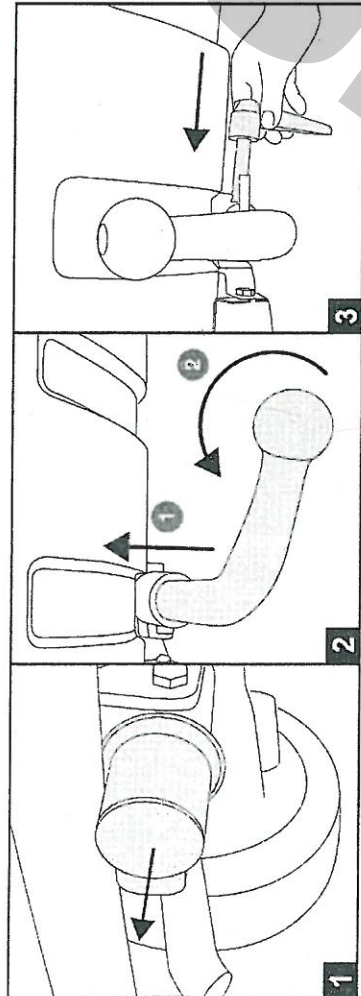

**FAC SIMILE**