

KD2PR/FL

KammBar

Instructions

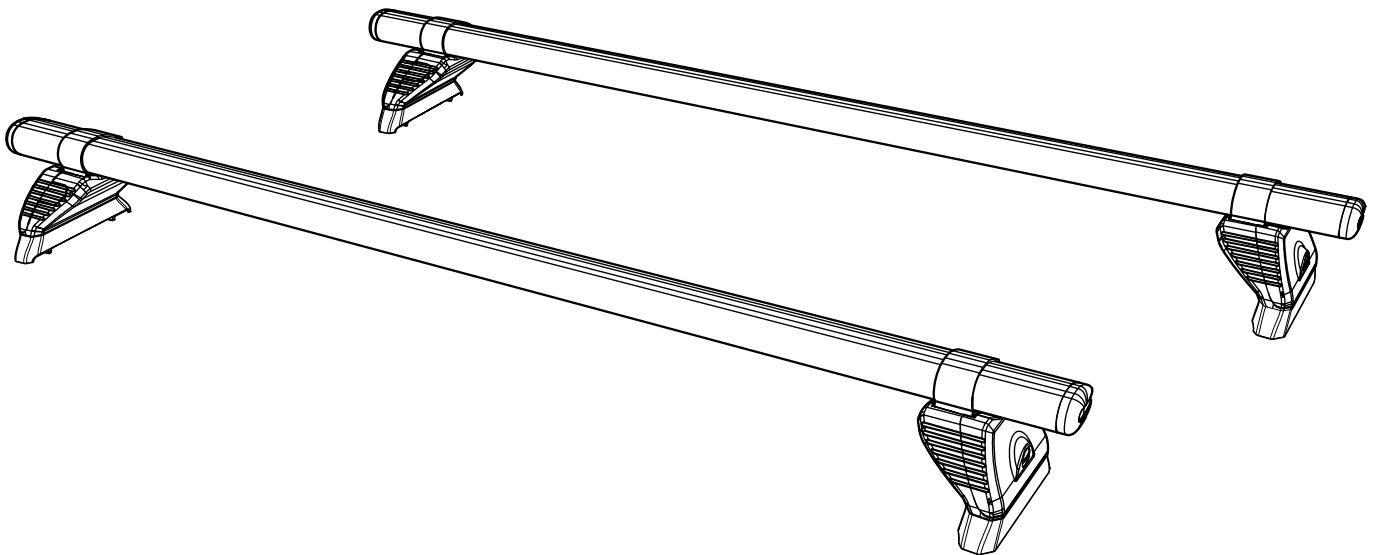

CITY CRASH (✓)

According to ISO/ PAS 11154:2006

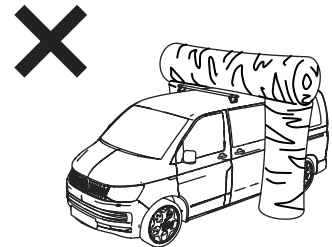
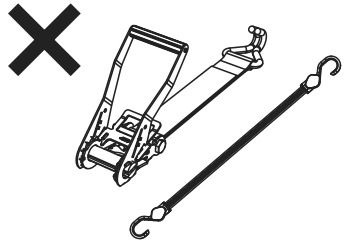
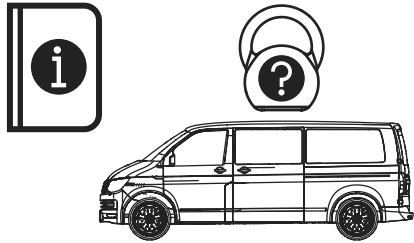
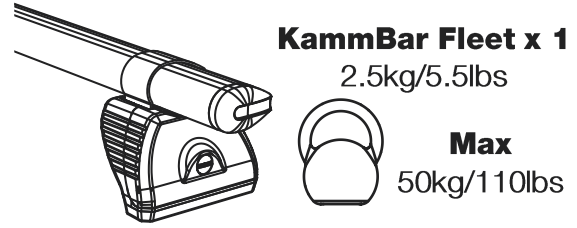
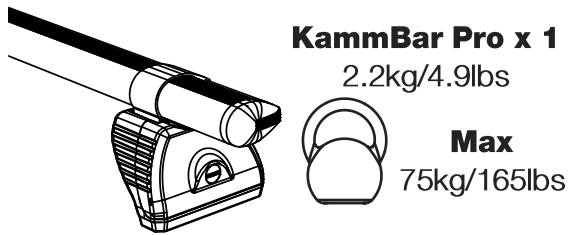

KammBar Pro

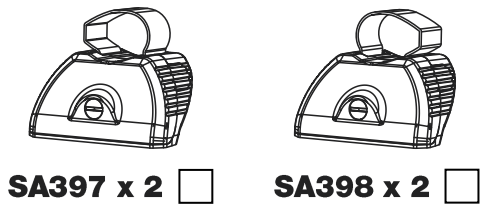
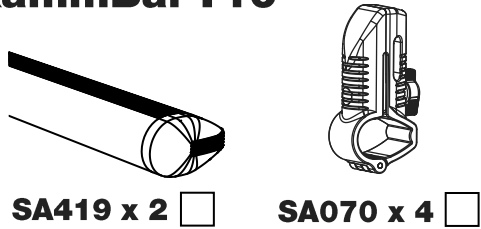

KammBar Fleet

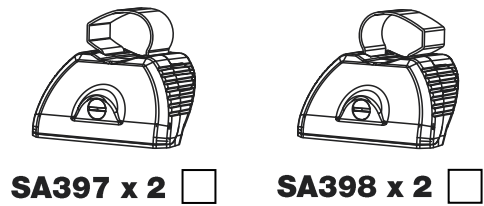
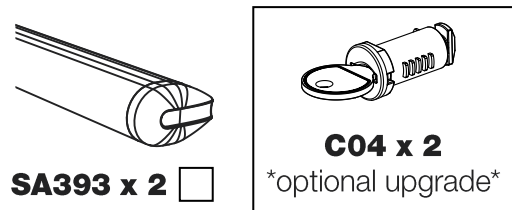

Fitting Kit

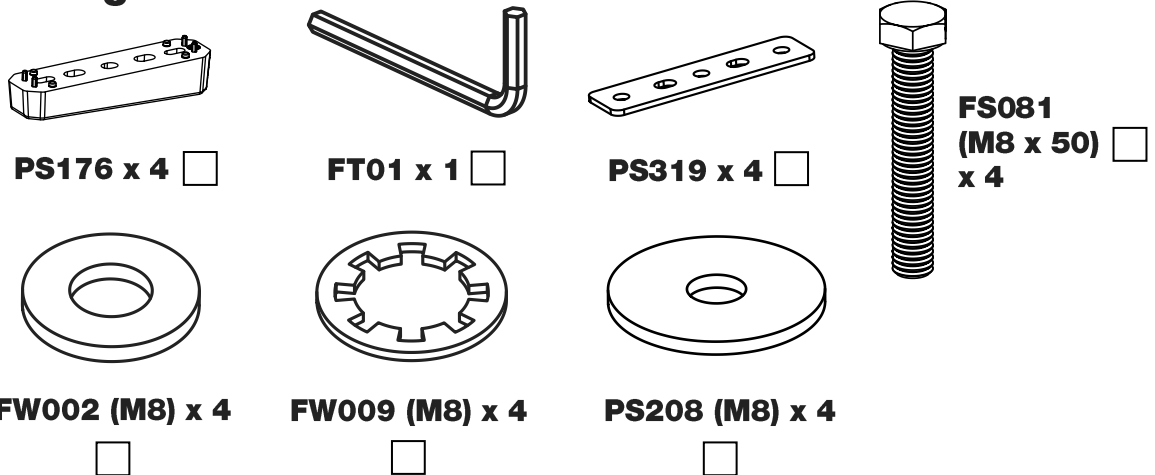

1.

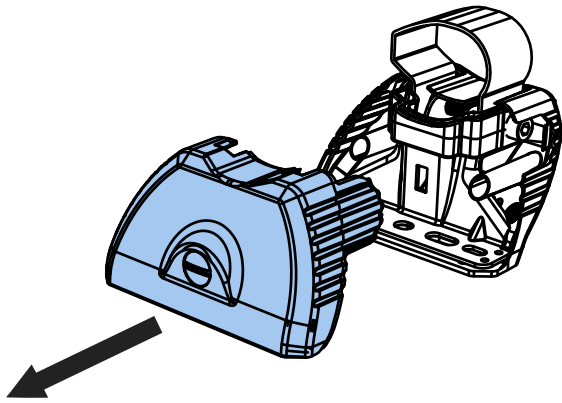

2.

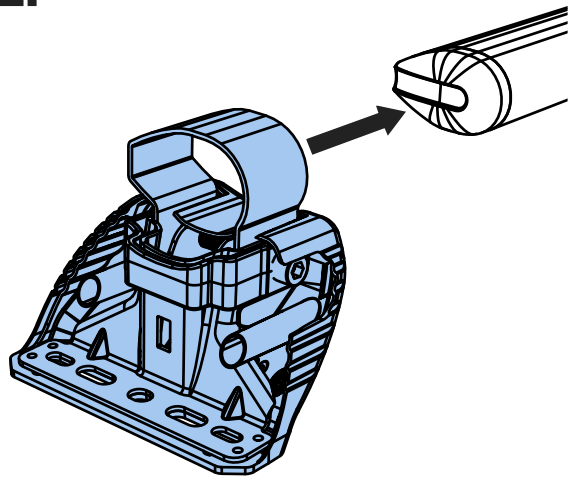

3.

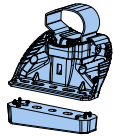

SA397

PS176

SA398

PS176

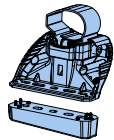
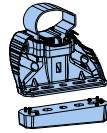

SA397

PS176

SA398

PS176

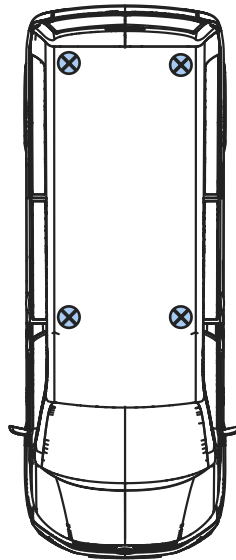
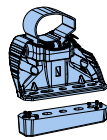

4.

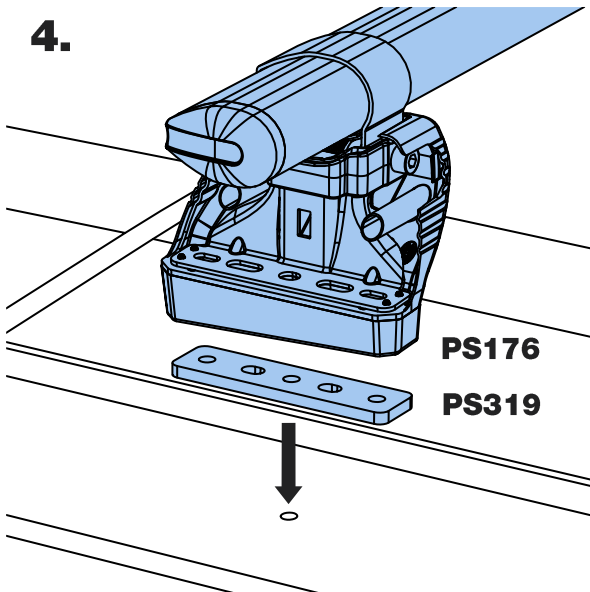

5.

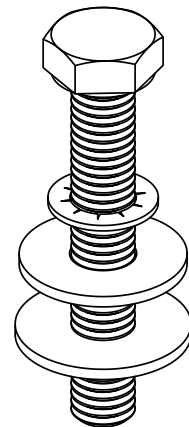

FS081

FW009

FW002

PS208

M8 x 50mm

6.

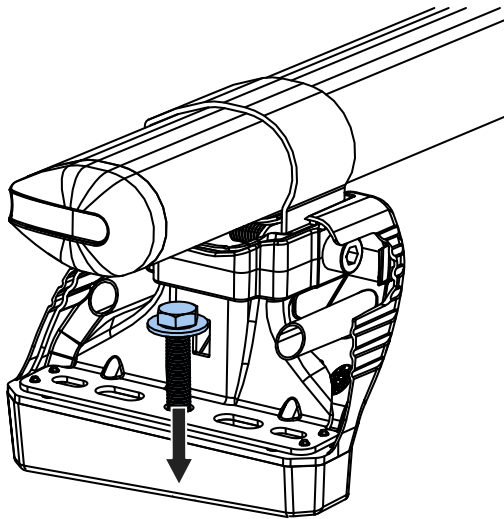

PS176 + M8 x 50mm

7.

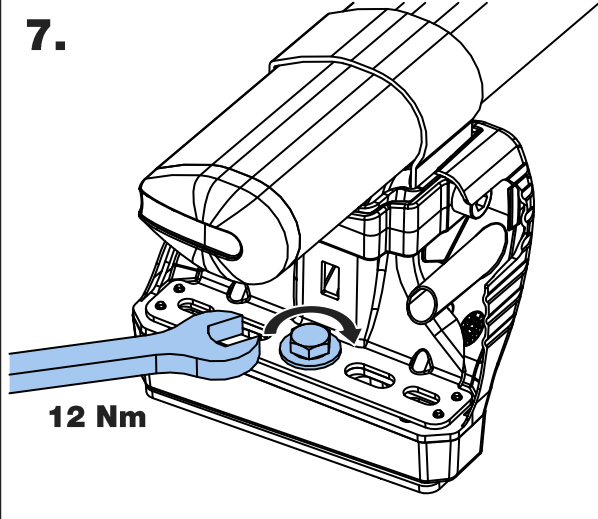

12 Nm

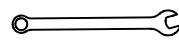

13mm

8.

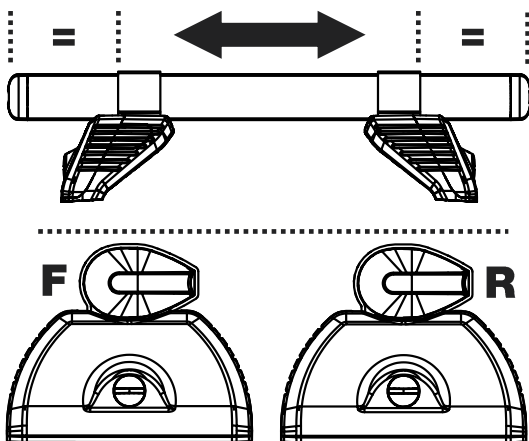

9.

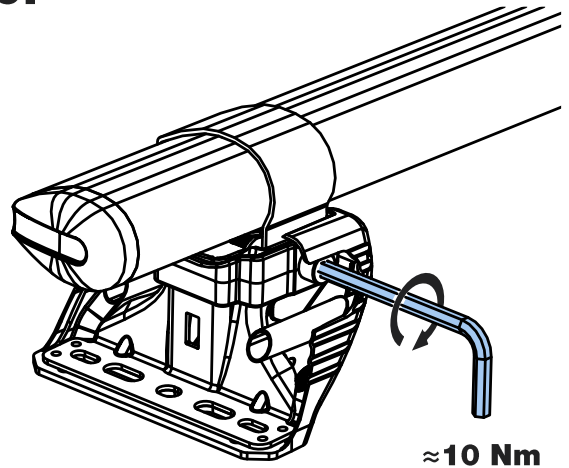

≈ 10 Nm

10.

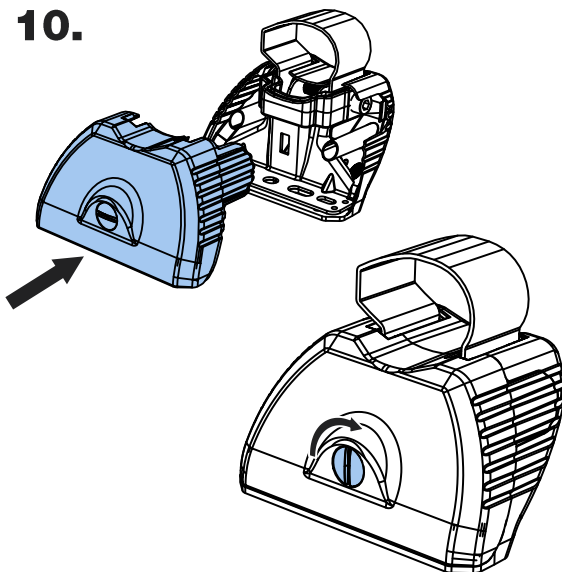

11.

