



VW

CRAFTER VAN

single wheels, FWD,
with footboard (L3-3640, L4-4490)

MAN

TGE VAN

single wheels, FWD,
with footboard (L3-3640, L4-4490)

09/2016 -
02/2017 -

Cat. No. W/055

E20

E20*55R02/00*006164*00

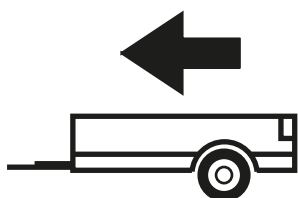

3 500kg

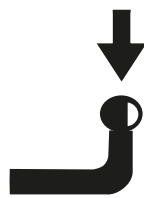

150kg

D = 20,55kN

D (kN) =



MAX kg

x

MAX kg

x 0,00981



MAX kg

+

MAX kg



IMIOLA HAK-POL

96-111 KOWIESY, CHOJNATA 23A, POLAND

tel. +48 46 831 73 31, fax +48 831 74 29

e-mail: office@imiola.pl, www.imiola.pl

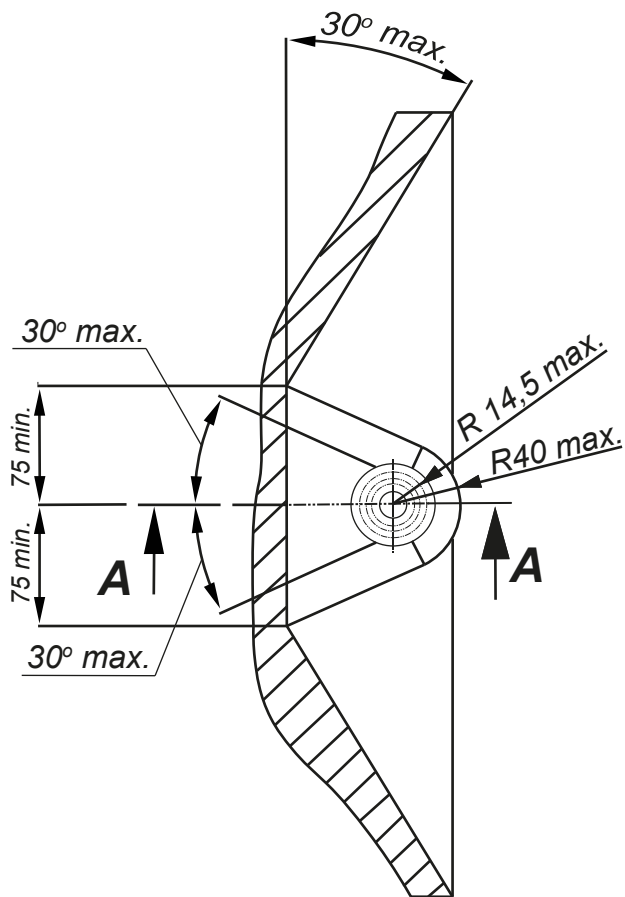

PRZEKRÓJ A-A

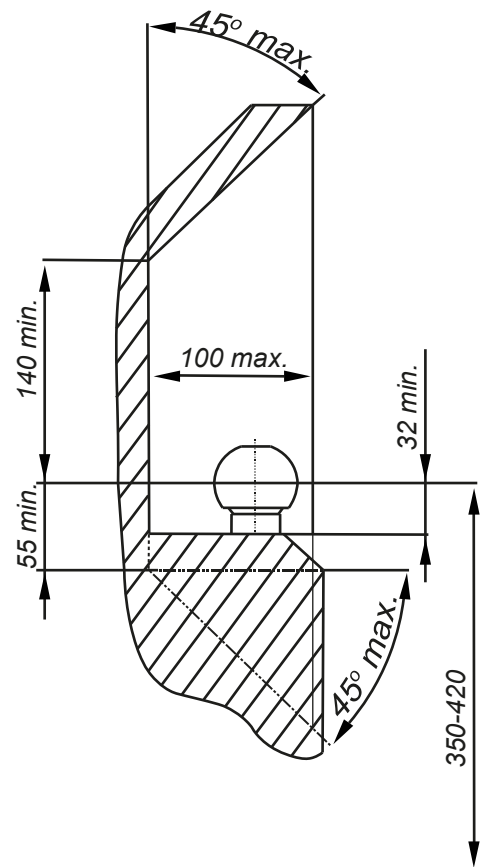

PL Należy zagwarantować przestrzeń swobodną według załącznika VII, rysunek 25a/b Regulaminu EKG ONZ 55.01 przy dopuszczalnym ciężarze całkowitym pojazdu.

F L'espace libre doit être garanti conformément à l'annexe VII, illustration de la réglementation 55.01 CE pour un poids total en charge autorisé du véhicule.

GB The clearance specified in appendix VII, diagram 25a/b of Regulation No. 55.01 UN EU must be guaranteed at laden weight of the vehicle.

D Der Freiraum nach Anhang VII, Abbildung 25a/b der Vorschriften 55.01 EG ist zu gew 25a/b abzuwehren bei zulässigem Gesamtgewicht des Fahrzeuges.

Moment skręcący dla śrub i nakrętek (8.8) Torque settings for nuts and bolts (8.8)	
M8	25Nm
M10	55Nm
M12	85Nm
M14	135Nm
M16	195Nm

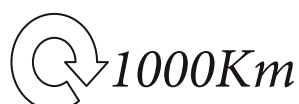

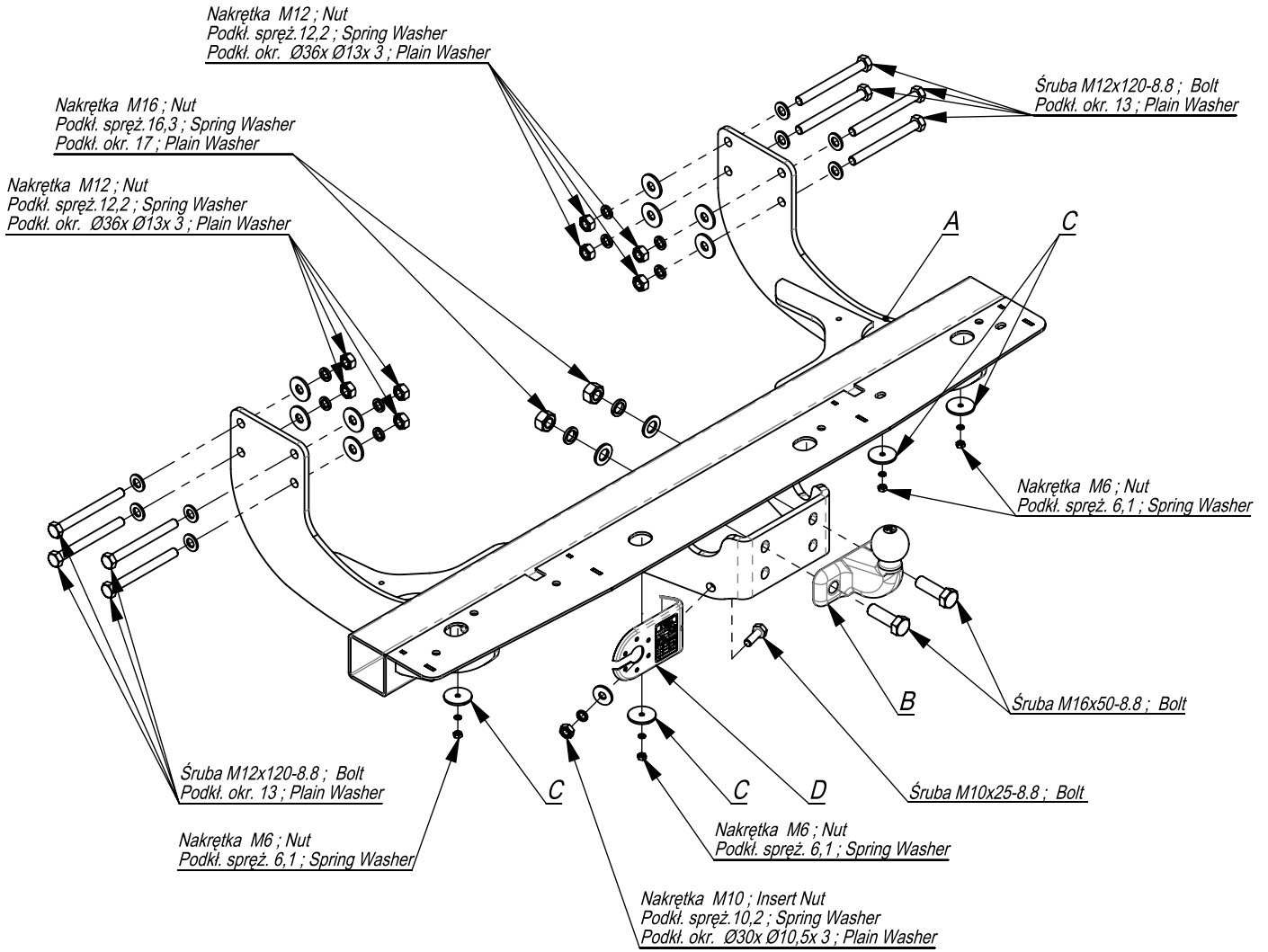

	A	x1		M12x120	8
				M16x50	2
				M10x25	1
				M16	2
				M12	8
				M10	1
	C	x4		M6	4
				Ø36xØ13x3	8
				Ø30xØ10,5x3	1
	D	x1		17	2
				13	8
				10,5	1
				16,3	2
				12,2	8
				10,2	1
				6,1	4

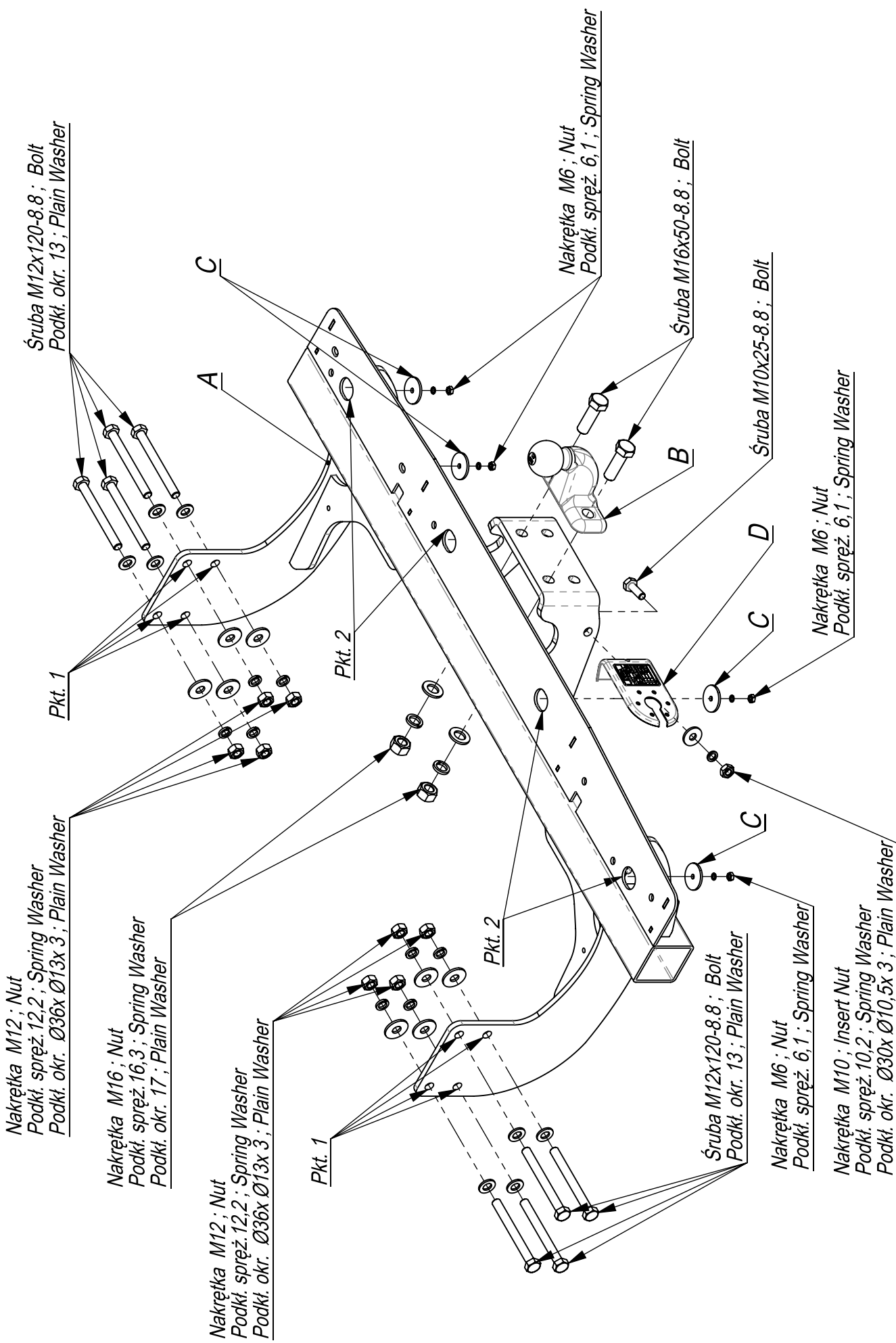

Nr katalogowy Marka

W/055

VW Crafter van, single wheels, FWD, with footboard (L3-3640,L4-4490) od 09/2016 ->

MAN TGE van, single wheels, FWD, with footboard (L3-3640,L4-4490) od 02/2017 ->

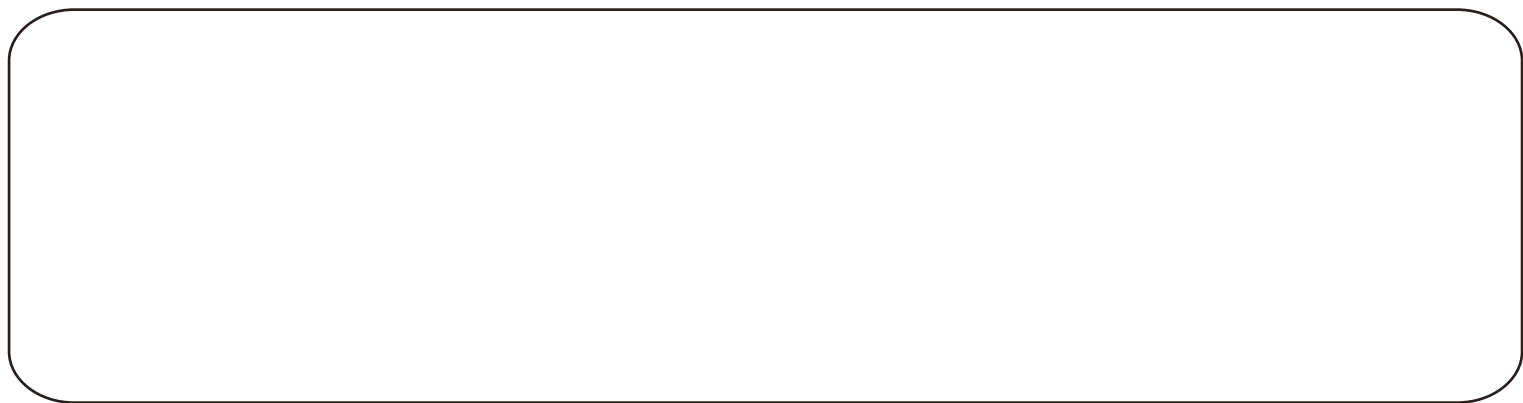

96-111 Kowiesy, Chojnata 23 A
tel. +48 46 831 73 31

An empty rounded rectangular box with a thin black border and rounded corners, intended for text input.An empty rounded rectangular box with a thin black border and rounded corners, intended for text input.An empty rounded rectangular box with a thin black border and rounded corners, intended for text input.An empty rounded rectangular box with a thin black border and rounded corners, intended for text input.An empty rounded rectangular box with a thin black border and rounded corners, intended for text input.

