

| | | |
|----|--|------------------------|
| ES | Instrucción de montaje ¡Leer primero! | Barras de aluminio |
| EN | Assembly instructions Read first! | Aluminium bars |
| FR | Instruction de montage Lire en premier! | Barres d'aluminium |
| DE | Montageanleitung Zuerst lesen! | Aluminiumdachträger |
| PT | Instruções de montagem Ler primeiro! | Barras d'alumínio |
| IT | Istruzioni di montaggio Leggere per primo! | Barre di alluminio |
| NL | Montagehandleiding Eerst lezen! | Aluminium dakdragers |
| PL | Instrukcja montażu Najpierw przeczytaj! | Belki aluminiowe |
| CZ | Montážní návod Čtěte pozorně! | Hliníková sada tyčí |
| HU | Szerelési Utasítás Először olvasd el! | Alumínium rudak |
| HR | Detaljne upute Prvo procitati! | Bare din aluminiu |
| RO | Instructiuni de montaj Intai cititi! | Aluminijske šipke |
| RU | Инструкции по монтажу Сначала прочитайте! | Алюминиевые поперечины |
| GR | Διαβάστε προσεκτικά τις Οδηγίες Συναρμολόγησης! | Μπάρες Αλουμινίου |
| TR | Öncelikle montaj: Talimatlarını okuyunuz! | Alüminyum barlar |
| SI | Navodila za sestavljanje Preberite! | Aluminijske prečke |

925-80x

Lv7 2023-r2

Modelo-model:

CRUZ Airo

Lote-Lot-Lot-Lot:



Peso-Weight-Poids-Gewicht:

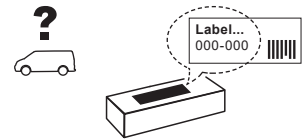

 Kit A: **Max. 60 kg / 132 lbs**
Kit B: **Max. 75 kg / 165 lbs**
Kit C,D,E: **Max. 75 kg / 165 lbs**
Kit R: **Max. 75 kg / 165 lbs**

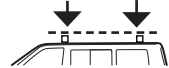

CEE - EEC type approval:

 26 R- 04 3040



CITY CRASH 

CRUZBER SAU
ES-A14018311
P.I. Las Salinas II
14960 - Rute - Spain
www.cruz-products.com



1.



ES Contenido embalaje: ¡Verificar!

x1

x1

EN Package content: Check!

FR Contenu d'emballage: Vérifier!

DE Packungsinhalt: Überprüfen!

PT Contéudo embalagem:
Verificar!IT Contenuto della confezione:
Controllare!

NL Pakket inhoud: Controleer!

PL Zawartość opakowania:
sprawdź!

CZ Obsah balení: Zkontrolujte!

HU Csomag tartalma: Ellenőrizd!

HR Sadržaj paketa: Provjeri!

RO Pachetul contine: Verificati!

RU Содержание упаковки:
Проверьте!GR Ελέγξτε το περιεχόμενο: του
πακέτου!





TR Paket içeriğini: Control ediniz!

SI Vsebina paketa: Preverite!

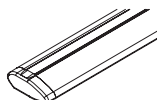

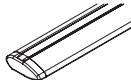
x2



| Código Code |  |  |  |  | Lote Lot |
|-------------|---|---|---|---|----------|
| 925-801 | CRUZ Airo 108 | 108 cm / 43" | 2x (749-064) 1x (749-053) | 2,86 kg / 6,30 lbs | 02/23 |
| 925-803 | CRUZ Airo 118 | 118 cm / 46" | 2x (749-066) 1x (749-053) | 3,05 kg / 6,72 lbs | 02/23 |
| 925-805 | CRUZ Airo 128 | 128 cm / 50" | 2x (749-067) 1x (749-053) | 3,30 kg / 7,27 lbs | 02/23 |
| 925-806 | CRUZ Airo 133 | 133 cm / 52" | 2x (749-068) 1x (749-053) | 3,40 kg / 7,49 lbs | 02/23 |
| 925-807 | CRUZ Airo 138 | 138 cm / 54" | 2x (749-069) 1x (749-053) | 3,49 kg / 7,69 lbs | 02/23 |

2.



Importante!
Important!
Important!
Wichtig!

- ES Estas barras tienen que usarse con Kits de fijación CRUZ!
- EN Bars must be used with CRUZ fixation Kits!
- FR Les barres devront être utilisées avec les Kits de fixation CRUZ!
- DE Die Dachlsträger nur mit CRUZ Stützfuß-Kits befestigen!
- PT As barras devem ser utilizadas com os Kits de fixação CRUZ!
- IT Questa bare deve essere utilizzato solo con il kit di fissaggio CRUZ!
- NL Dakdragers moeten worden gebruikt in combinatie met de bevestigingssets van CRUZ!

- PL Belki muszą być stosowane z elementami mocującymi firmy CRUZ!
- CZ Tento nosič musí být používán s fixačním kitem CRUZ!
- HU A rudakat csak CRUZ rögzítő készlettel szabad használni!
- HR Šipke moraju biti korištene sa CRUZ kitovima za montažu!
- RO Barele trebuie utilizate cu Kit-uri de fixare CRUZ!
- RU Поперечины должны быть использованы со специальным крепежным комплектом CRUZ!
- GR Το αξεσουάρ αυτό θα πρέπει να χρησιμοποιείται αποκλειστικά στα συστήματα μπαρών της CRUZ!
- TR Bu barlar mutlak CRUZ montaj kiti!
- SI Prečke je potrebno uporabiti s CRUZ kiti za pričvrščanje

1

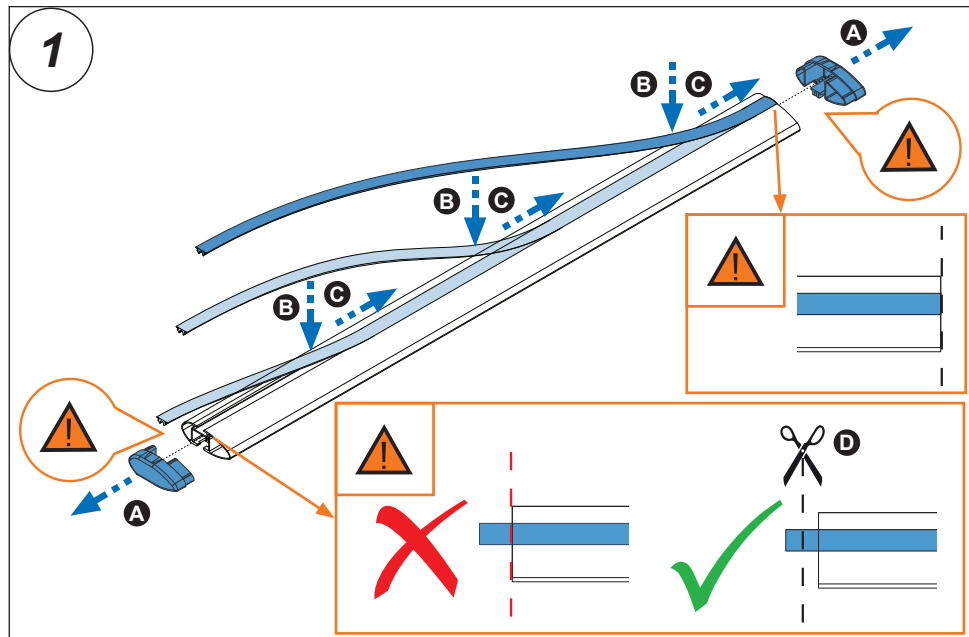

2



JUEGO DE PIES / FIXING FEET KIT

